

LOS ANGELES COUNTY
DEPARTMENT OF PUBLIC WORKS
BENCH MARK LIST



LLANO QUAD

1998 ADJUSTMENT

**NAVD 88 DATUM
METRIC**

PREFACE
1998 LLANO QUAD

The Department of Public Works level net is composed of more than 1,700 miles (2720 kilometers) of levels supporting in excess of 9,000 bench marks. Previously when a major readjustment of the net was undertaken, the CY, CG, & CL series bench marks were re-labeled DY, DG, & DL, respectively.

Beginning in 1993, the baseline readjustment year will be indicated on baseline BM'S only, as indicated below (*). Henceforth, all BM numbers will be labeled as a Y, G, or L, series. This designation will no longer indicate the major adjustment year.

To facilitate the adjustment, indexing and distribution of adjusted values of the net, the county territory was divided into 33 quads or areas. For identification purposes, each quad was given a name, i.e., "Rosemead", "La Mirada", "Santa Fe", etc. When bench marks and elevations in these quads are used, the name must be included in the bench mark description as shown below,

* BASELINE 90.057 L&BR IN CTR OF CB RET @ NE COR LA HABRA BLVD Y 9191
(1990) 295.461 & VALLEY HOME AVE 10.7M N & 10.7. E/O C/L INT

Updating constrained adjustments will continue in the future. When a quad is readjusted, new elevations will be published and the date of readjustment will be noted in the bench mark description. Two bench marks with different adjustment dates will not normally agree with each other.

The basic accuracy of the net is reflected by an indicated field probable error of plus or minus 4mm per kilometer of leveling as determined from the conditions of closure. However, many years of experience in vertical control in the greater Los Angeles basin and Antelope Valley indicate that because of varying subsidence and heaving, the true datum is recovered only by obtaining substantial agreement from a number of different bench marks.

The users of this net are invited to assist in its maintenance by notifying this department in cases of obliteration, apparent mistakes in description or elevations, and proven disturbance of bench marks.

DATUM: North American Vertical Datum of 1988 (NAVD88)

NAVD 1988 Datum minus approximately 900mm (3.00ft) equals previous NGVD 1929 Datums. For more accurate equations at individual bench marks refer to previous publications.

ABBREVIATIONS USED IN BENCH MARK LISTINGS

ABUT -----	Abutment	ECR -----	End of Curb Return
ALG -----	Along	EC -----	End of Curve
ANG PT -----	Angle Point	ENT -----	Entrance
B/W -----	Back of Walk	FL -----	Floor
BCR -----	Beginning of Curb Return	FTG -----	Footing
BC -----	Beginning of Curve	FRWY -----	Freeway
BLDG -----	Building	F/W -----	Front of Walk
BM -----	Bench Mark	GAR -----	Garage
BT SPK -----	Boat or Bolt Spike	HDWL -----	Headwall
BR CAP -----	Brass or Bronze Cap	HSE -----	House
C B -----	Catch Basin	HWY -----	Highway
CTR -----	Center	INT -----	Intersection
C/L -----	Center Line	IP -----	Iron Pipe
C/L INT -----	Center Line Intersection	LT -----	Left
C/L PROD -----	Center Line Produced	LACE -----	L.A. City Engineer
CONC -----	Concrete	LACS -----	L.A. Co. Engineer
COR -----	Corner	LAFC -----	L.A. Co. Flood Control
COE -----	Corps of Engineers	L&BN -----	Lead and Bench Nail
CULV -----	Culvert	L&BR -----	Lead and Brad
CYN -----	Canyon	L&N -----	Lead and Nail
CB -----	Curb	L&SPK -----	Lead and Spike
CS MON -----	Co. Eng. Monument	L&T -----	Lead and Tack
CT SPK -----	Cut Spike	MCR -----	Middle of Curb Return
DPW -----	Dept. of Public Works	MKD -----	Marked
DR -----	Drive or Driveway	MC -----	Middle of Curve
E/O -----	East of	MON -----	Monument

ABBREVIATIONS USED IN BENCH MARKS (CON'T)

N/O ----- North of
NR ----- Near
OPP ----- Opposite
PI ----- Point of Intersection
PK&W ----- PK Nail and Washer
P/L ----- Property Line
POST ----- Point of Semi-Tangent
PP ----- Power Pole
PVMT ----- Pavement
PROD ----- Produced
RD ----- Road
RDBM ----- Road Dept. Bench Mark
RDBM TAG ----- Road Dept. Bench Mark Tag
RR ----- Railroad
RT ----- Right
R/W ----- Right of Way
SDMH ----- Storm Drain Manhole
SMH ----- Sewer Manhole
SPK ----- Spike
ST&W ----- Spike Tin and Washer
S/O ----- South of
TP ----- Telephone Pole
USC&GS ----- U.S. Coast and Geodetic Survey
USGS ----- U.S. Geological Survey
WK ----- Walk
W/O ----- West of

E A S T

Q U A D

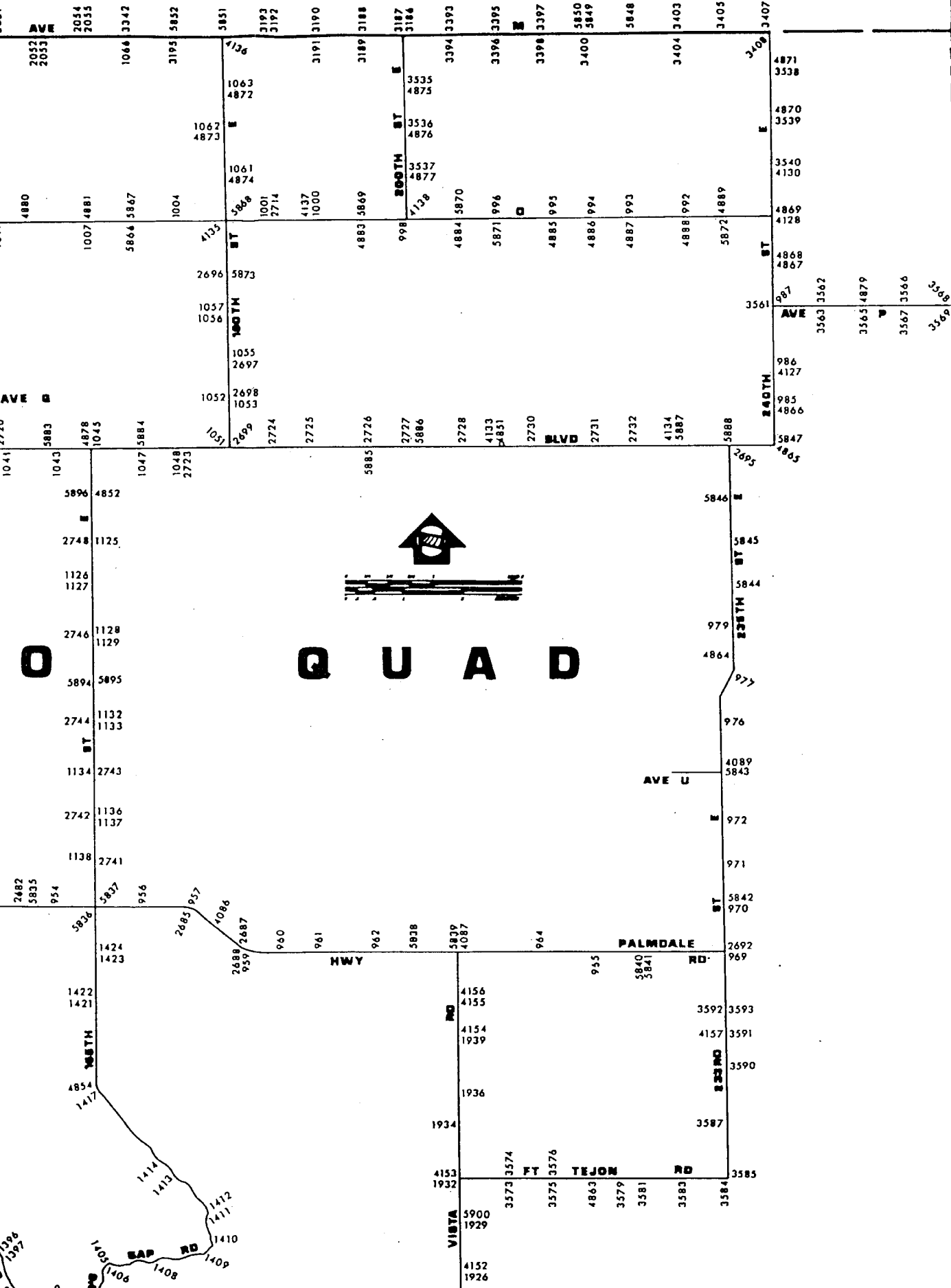

B E R N A R D I N O

C O U N T Y

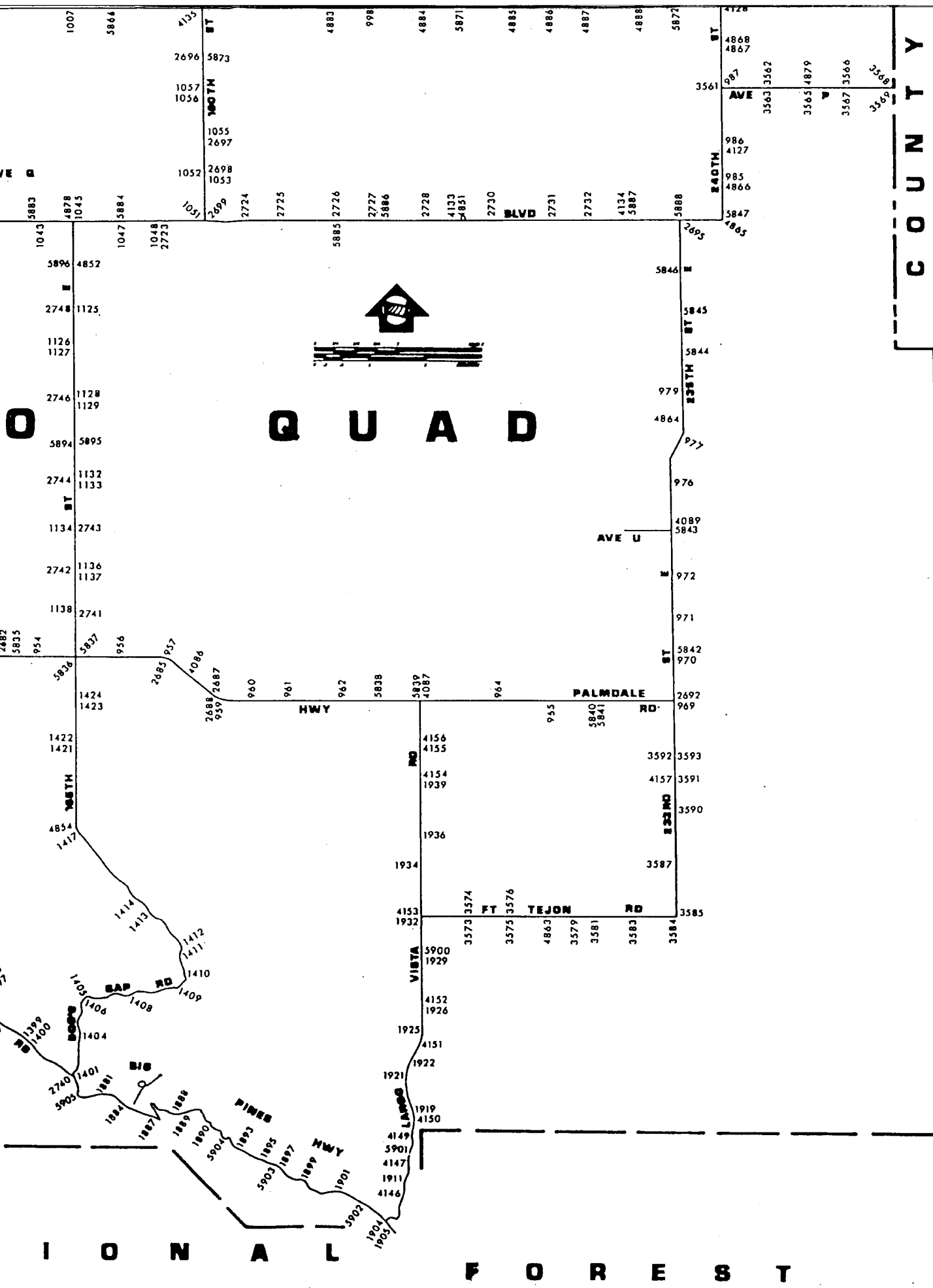

O Q U A D

S A N B E R N A R D I N O C O U N T Y

N A T I O N A L F O R E S T



AVE R

BLVD

240TH ST

AVE U

PALMDALE RD

VISTA RD

FT TEJON RD

SAP RD

PINES HWY

PALMDALE

PALMDALE

LANCASTER EAST

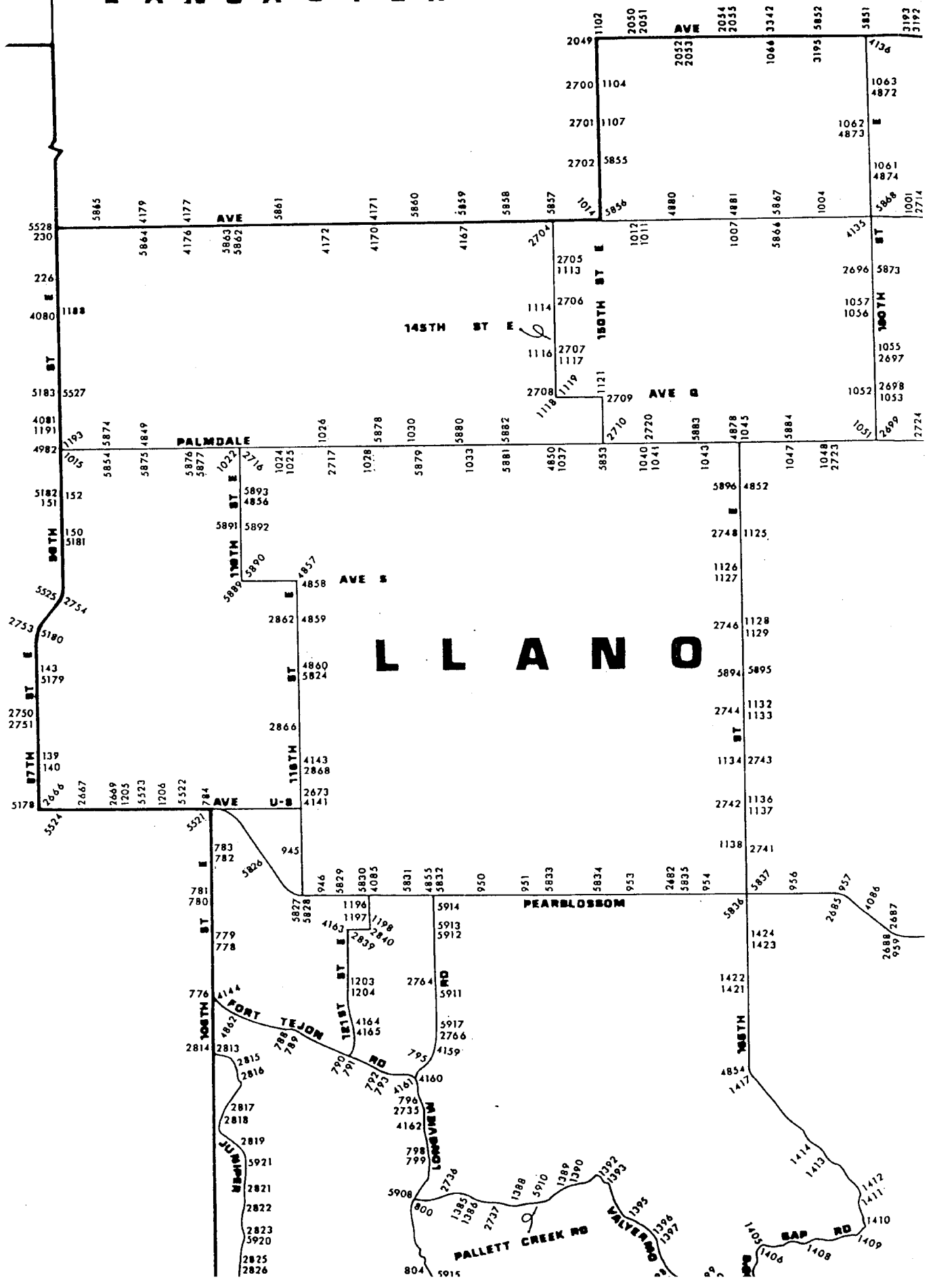

LLANO

PEARLBLOSSOM

PALMDALE

PALMDALE

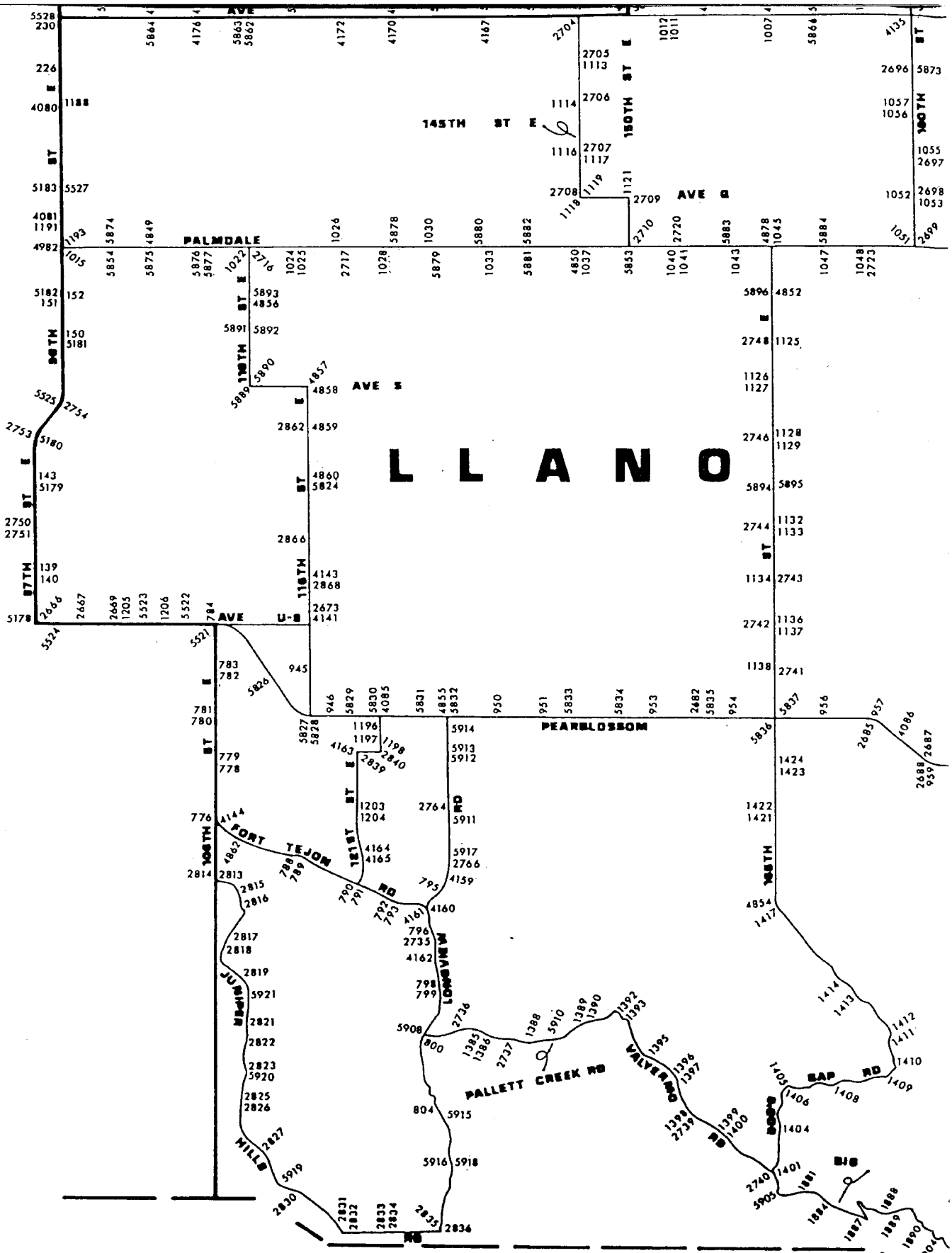

ANGELLES NATION

QUAD-YEAR	ELEV METER/FOOT	DESCRIPTION (INCLUDE QUAD AND YEAR IN DESCRIPTION)	BM NUMBER
BASELINE (1998)	0871.816 2860.283	CS MON IN WELL 600MM DN @ C/L INT AVE U & 87TH ST E MKD (SEC 12,13,34,35,T5N,R11W)	L 139
BASELINE (1998)	0872.791 2863.482	RDBM TAG IN N SIDE CONC FTG OF 50MM FENCE POST 41M W/O C/L 87TH ST E & 7.6M S/O C/L AVE U	L 140
BASELINE (1998)	0847.233 2779.630	CS MON IN WELL 300MM DN ON C/L AVE T & 87TH ST E MKD (SEC 1,6,12,7,T5N,R10W)	L 143
BASELINE (1998)	0819.455 2688.495	RDBM TAG @ SW COR OF CONC SLAB 9.4M N/O C/L AVE R-8 & 13.7M E/O C/L 90TH ST E	L 150
BASELINE (1998)	0815.171 2674.440	L&T IN SE COR CONC SLAB @ SE COR OF BLOCK BLDG #37855 90TH ST E 39.6M W C/L & 152M N/O AVE R-4	L 151
BASELINE (1998)	0812.651 2666.172	CS MON IN WELL 375MM DN @ C/L INT 90TH ST E & AVE R MKD (SEC 29,30,31,32,R10W,T6N)	L 152
BASELINE (1998)	0790.051 2592.026	CS MON IN WELL 600MM DN @ C/L INT 90TH ST E & AVE O-8 MKD (1/4 COR 18,17,T6N,R10W) 11M SW/O PP #373162E	L 226
BASELINE (1998)	0786.064 2578.945	RDBM TAG IN CONC FENCE FTG @ EDISON SUB STA @ SE COR 90TH ST E & AVE O 9M E & 9M S/O C/L INT	L 230
BASELINE (1998)	0996.340 3268.825	RDBM MON IN WELL 200MM DN @ SW COR FT TEJON RD & 106TH ST E 30.5M S & 15M W/O C/L INT MKD 1958 IP MKR 600MM W/O MON	L 776
BASELINE (1998)	0965.552 3167.815	CS MON IN WELL 600MM DN @ C/L INT 106TH ST E & AVE W (PROP) 805M N/O FT TEJON RD MKD (SEC COR 20,21,28,29,R10W,T5N)	L 778
BASELINE (1998)	0966.724 3171.660	RDBM TAG IN WELL 200MM DN @ NE COR 106TH ST E & AVE W PROP 30.5M N & 15M E/O C/L INT 835M N FORT TEJON RD MKD (1960) IP MKR 600MM E/O MON	L 779
BASELINE (1998)	0950.727 3119.177	RDBM MON IN WELL 200MM DN @ SW COR 106TH ST E & AVE V-8 27.4M S & 15M W/O C/L INT 50MM 1P MKR 600MM W/O MON	L 780
BASELINE (1998)	0950.306 3117.796	40MM IP WITH CUT SPK IN WELL 200MM DN @ C/L INT 106TH ST E & AVE V-8	L 781
BASELINE (1998)	0929.371 3049.111	L&T IN SLY CONC FTG OF DWP TOWER #H220-1 @ SW COR 106TH ST E & AVE V 58M S & 17M W/O C/L INT	L 782
BASELINE (1998)	0927.388 3042.605	CS MON IN WELL 450MM DN @ C/L INT 106TH ST E & AVE V MKD (16,17,20,21,T5N,R10W)	L 783

QUAD-YEAR	ELEV METER/FOOT	DESCRIPTION (INCLUDE QUAD AND YEAR IN DESCRIPTION)	BM NUMBER
BASELINE (1998)	0904.328 2966.949	USGS MON UP 250MM @ SW COR PEARBLOSSOM HWY & 106TH ST E 19M S & 13M W C/L INT MKD LS 23 1929	L 784
LLANO (1998)	1034.839 3395.134	RDBM MON 150MM DN 17M S/O C/L FT TEJON RD & 99M E/O BUTTERFIELD STAGE RD MKD (PT 1960) MKR POST 600MM S/O MON	L 788
LLANO (1998)	1038.141 3405.968	RDBM MON IN WELL FL DN 17M S C/L FT TEJON RD & 260M E/O BUTTERFIELD STAGE RD MKR POST 600MM S/O MON	L 789
LLANO (1998)	1059.631 3476.473	RDBM MON IN WELL 200MM DN @ SW COR FT TEJON RD & 121ST ST E 28M S & 18M W/O C/L INT MKR POST 600MM S/O MON	L 790
LLANO (1998)	1060.670 3479.881	RDBM MON IN WELL FLUSH @ SW COR FT TEJON RD & 121ST ST E 52M S & 8M W/O C/L INT 1.2M N/O PP #1201431E MKR POST 600MM W/O MON	L 791
LLANO (1998)	1073.468 3521.870	RDBM MON 200MM DN @ SW COR FT TEJON RD & DIRT RD TO N 483M W/O LONGVIEW RD TO N 30.5M S & 61M W/O C/L INT MKD (1960) MKR POST 300MM S/O MON	L 792
LLANO (1998)	1074.683 3525.856	RDBM MON IN WELL 8IN DN @ SE COR FT TEJON RD & DIRT RD TO N 483M W/O LONGVIEW RD TO N 23M S & 46M E/O C/L INT MKR POST 600MM S/O MON	L 793
LLANO (1998)	1059.271 3475.292	RDBM MON IN WELL @ NW COR LONGVIEW RD & HOMER RD 15M W & 12M N/O C/L INT 161M N/O FT TEJON RD MKD (1960) MKR POST 600MM N/O MON	L 795
LLANO (1998)	1080.643 3545.410	SPK&BM TAG IN NW WINGWALL BRIDGE B-980 4.6M W C/L LONGVIEW RD & 76M N/O C/L FT TEJON RD S	L 796
LLANO (1998)	1132.679 3716.131	RDBM MON IN WELL 200MM DN 8M W C/L LONGVIEW RD & 885M S/O FT TEJON RD MKD (1960) MKR 600MM W	L 798
LLANO (1998)	1137.169 3730.862	RDBM MON IN WELL 8.5M W C/L LONGVIEW RD & 966M S/O FT TEJON RD MKD (1960) MKR 600MM W/O MON	L 799
LLANO (1998)	1170.030 3838.673	RDBM MON IN WELL 200MM DN @ SE COR LONGVIEW RD & PALLETT CREEK RD 11M S & 49M E/O C/L INT MKD MKD (1960) MKR POST 600MM S/O MON	L 800
LLANO (1998)	1178.356 3865.990	RDBM MON IN WELL 200MM DN 1.5M N PP (NO#) 23M E/O C/L LONGVIEW RD 805M S/O PALLETT CREEK RD MKD (1960) MKR POST 600MM E/O MON	L 802

QUAD-YEAR	ELEV METER/FOOT	DESCRIPTION (INCLUDE QUAD AND YEAR IN DESCRIPTION)	BM NUMBER
LLANO (1998)	1180.859 3874.202	RDBM MON IN WELL 200MM DN 1M W/O PP (NO#) 10M W/O C/L LONGVIEW RD 885M S/O PALLETT CREEK RD MKD (1960) MKR POST 600MM W/O MON	L 803
LLANO (1998)	1216.972 3992.682	RDBM MON IN WELL 100MM DN @ NE COR LONGVIEW RD & TUMBLEWEED RD 38M N & 15M E/O C/L INT MKD (1960) MKR POST 600MM W/O MON	L 804
LLANO (1998)	0921.406 3022.980	USC&GS MON 200MM UP 5M E C/L 116TH ST E & 134M S/O AVE V 13M SW/O PP #4072951E MKD (J 306 1935) 50MM IP MKR POST 600MM E/O MON	L 945
LLANO (1998)	0935.359 3068.757	CSBM MON FL 11M N/O C/L W BND PEARBLOSSOM HWY & 111M E/O C/L 116TH ST E 1.5M E/O PP #1017 MKD (BM 106-28 1958) MKR POST 360MM S/O MON	L 946
LLANO (1998)	0943.819 3096.513	CSBM MON 150MM DN 14M S/O C/L PEARBLOSSOM HWY & 966M E/O 131SR ST E 119M ELY OF TP STUB #29 MKD (BM 106-32 1958) MKR POST 550MM N/O MON	L 950
LLANO (1998)	0954.494 3131.536	CSBM MON 100MM DN 14M S/O C/L PEARBLOSSOM HWY & 2.4K E/O 131ST ST E 73M ELY OF TP STUB #29 MKD (BM 106-33 1958) MKR POST 450MM N/O MON	L 951
LLANO (1998)	0964.856 3165.532	CSBM MON 600MM DN 14M S/O C/L PEARBLOSSOM HWY & 1.6K W/O 165TH ST E 28M ELY OF TP STUB #34 MKD (BM 106-34 1958) MKR POST 600MM N/O MON	L 953
LLANO (1998)	0965.462 3167.520	BT SPK IN SE WINGWALL OF BRIDGE #53-314 5.5M S/O C/L PEARBLOSSOM HWY & 1K W/O 165TH ST E	L 954
LLANO (1998)	0971.717 3188.042	CSBM MON FLUSH 13M N & 30M W/O C/L PEARBLOSSOM HWY & 170TH ST E 16M E/O PP #1404342 MKD (106-38 1958) MKR POST 600MM S/O MON	L 956
LLANO (1998)	0975.495 3200.437	CSBM MON 100MM UP 14M N & 24M E/O C/L INT 175TH ST E & PEARBLOSSOM HWY MKD (BM 106-39 1958) MKR POST 600MM S/O MON	L 957
LLANO (1998)	1001.977 3287.320	CSBM MON 100MM UP 28M S & 41M E/O C/L INT AVE W & PEARBLOSSOM HWY 16M S/O PP #1404305E MKD (BM 106-41 1958) MKR POST 300MM N/O MON	L 959
LLANO (1998)	1006.779 3303.074	CSBM MON FLUSH 11M N/O C/L PEARBLOSSOM HWY & 885M E/O CURVE @ AVE W 2.4M S/O PP (NO#) MKD (BM 106-42 1958) MKR POST 30MM S/O MON	L 960
LLANO (1998)	1019.870 3346.023	CSBM MON FL 11M N/O C/L PEARBLOSSOM HWY & 1.8K E/O AVE W 2M S/O PP (NO#) MKD (BM 106-43 1958)	L 961

QUAD-YEAR	ELEV METER/FOOT	DESCRIPTION (INCLUDE QUAD AND YEAR IN DESCRIPTION)	BM NUMBER
LLANO (1998)	1031.938 3385.617	CSBM MON 100MM UP 11M N/O C/L PEARBLOSSOM HWY & 152M W/O 198TH ST E 2M N/O PP (NO#) MKD (BM 106-44 1958) MKR POST 300MM S/O MON	L 962
LLANO (1998)	1036.857 3401.755	CSBM MON FLUSH 12M N/O C/L PEARBLOSSOM HWY & 885M E/O LARGO VISTA RD (204TH ST E) 1M E/O PP (NO#) MKD (BM 106-46 1958) MKR 300MM N/O MON	L 964
LLANO (1998)	1036.756 3401.424	CSBM MON 100MM UP 12M N/O C/L PEARBLOSSOM HWY & 402M E/O 213TH ST E 15M W/O DIRT RD TO N 1.5M E PP (NO#) MKD (BM 106-47 1958) MKR 300MM S MON	L 965
LLANO (1998)	1035.839 3398.415	CSBM MON @ SW COR 233RD ST E & PALMDALE RD 34M S & 7.6M W/O C/L INT 1.5M N/O PP #777983E MKD (BM 106-51 1958) MKR POST 300MM N/O MON	L 969
LLANO (1998)	1014.823 3329.465	CSBM MON 100MM UP ON W SIDE 233RD ST E (DIRT RD) 805M N/O PALMDALE RD 600MM W/O PP (NO#) MKD (BM 106-52 1958) MKR POST 600MM W/O MON	L 970
LLANO (1998)	0996.187 3268.324	CS MON 12IN DN ON 233RD ST E (DIRT RD) 1.6K N/O PALMDALE RD & 322M N/O SPRR 6.4M NE/O FENCE COR MKD (15,16,21,22,T5N,R8W) MKR 600MM E/O MON	L 971
LLANO (1998)	0979.138 3212.389	CS MON FL 7.4M E/O C/L 233RD ST E (DIRT RD) & 2.4K N/O PALMDALE RD MKD (15,16,R8W,T5N,RE 329) 805M S/O AVE U MKR POST 600MM NE/O MON	L 972
LLANO (1998)	0952.160 3123.878	CS MON 450MM DN 5.3M W C/L 235TH ST E (DIRT RD) & 805M N/O AVE U MKD (9,10,R8W,T5N,RE 329) MKR POST 550MM E/O MON	L 976
LLANO (1998)	0941.637 3089.354	CS MON 7M W/O C/L 235TH ST E (DIRT RD) TO THE W 1.6K N/O AVE U MKD (RE 329,4,3,9,10,R8W,T5N) MKR POST 300MM N/O MON	L 977
LLANO (1998)	0926.186 3038.662	CSBM MON 150MM UP @ BASE SE RIDGE BLACK BUTTE 44M W/O C/L 235TH ST E 1.6M N/O AVE U MKD (BM 106-61 1958) MKR POST 600MM E/O MON	L 979
LLANO (1998)	0888.419 2914.755	CSBM MON FL 9.4M E/O C/L 240TH ST E & 33M S/O AVE Q 1M S/O PP #2274147E MKD BM 106-67 1958	L 985
LLANO (1998)	0881.149 2890.903	CSBM MON 150MM UP 9.4M E/O C/L 240TH ST E & 600MM N/O C/L AVE P-8 1.5M W/O PP #864351E MKD (BM 106-68 1958) MKR POST 600MM W/O MON	L 986
LLANO (1998)	0874.895 2870.385	CSBM MON FL 11M E C/L 240TH ST E & 58M N/O C/L AVE P 600MM S/O PP #1050 MKD (BM 106-69 1958) MKR POST 600MM W/O MON	L 987

QUAD-YEAR	ELEV METER/FOOT	DESCRIPTION (INCLUDE QUAD AND YEAR IN DESCRIPTION)	BM NUMBER
LLANO (1998)	0854.097 2802.150	CS MON IN WELL 640MM DN @ C/L INT AVE O & 230TH ST E 11M SE/O FENCE COR MKD (SEC COR 9,10,15,16 ,T6N,R8W)	L 992
LLANO (1998)	0849.340 2786.543	40MM IP & NAIL IN WELL 300MM DN @ C/L INT AVE O & 225TH ST E 70M SW/O PP (NO#) & 80M E/O E SIDE P/L HSE #22339	L 993
LLANO (1998)	0845.289 2773.252	CSBM MON 100MM UP 10.7M N/O C/L AVE O & 12.8M E/O C/L 220TH ST E 1.5M E/O PP #734973E MKD (BM 106-76 1958) MKR POST 600MM S/O MON	L 994
LLANO (1998)	0841.094 2759.489	CSBM MON FL 10.7M N/O C/L AVE O & 34M E/O C/L 215TH ST E 2M E/O PP #4337633E MKD (BM 106-77 1958) MKR POST 750MM SE/O MON	L 995
LLANO (1998)	0837.238 2746.838	CSBM MON FL 11M N/O C/L AVE O & 220FT E/O C/L 210TH ST E 1M W/O PP (NO#) MKD (BM 106-78 1958) MKR POST 300MM S/O MON	L 996
LLANO (1998)	0827.128 2713.669	USGS MON 350MM UP 12.5M N C/L AVE O & 21M W/O C/L 200TH ST E 6M W/O DIRT RD 62M W/O W SIDE HSE #20111 MKD (LS 33 1929) MKR 300MM S/O MON	L 998
LLANO (1998)	0818.323 2684.781	CSBM MON 100MM UP 11.3M N C/L AVE O & 1.6K E/O 180TH ST E MKD (BM 106-82 1959) MKR 600MM N MON	L 1000
LLANO (1998)	0814.155 2671.107	CSBM MON 150MM UP 10M N C/L AVE O & 644M E/O 180TH ST E 7M E/O PP (NO#) MKD (BM 106-8 1959) MKR POST 600MM N/O MON	L 1001
LLANO (1998)	0811.795 2663.364	CS MON IN WELL @ C/L INT AVE O & 175TH ST E MKD (1/4 COR 10,15,T6N,R9W,RE 2177)	L 1004
LLANO (1998)	0805.349 2642.216	CS MON IN WELL @ C/L INT AVE O & 165TH ST E MKD (1/4 SEC COR 9,16,T6N,R9W,RE 5869)	L 1007
LLANO (1998)	0813.484 2668.905	CS MON IN WELL @ C/L INT AVE O & 155TH ST E MKD (1/4 COR 8,17,T6N,R9W,RE 5869)	L 1011
LLANO (1998)	0813.415 2668.679	RDBM MON IN WELL W/COVER 12M S/O C/L AVE O & 37M W/O C/L 155TH ST E (PROP) MKR 600MM S MON	L 1012
LLANO (1998)	0807.559 2649.466	RDBM MON 150MM DN 1.5M NE/O PP (NO#) 11.6M N/O C/L AVE O & 111M W/O 150TH ST E MKD (1960) MKR POST 600MM N/O MON	L 1014
BASELINE (1998)	0806.787 2646.934	CS MON IN WELL @ C/L INT PALMDALE BLVD & 90TH ST E MKD (1/4 SEC 29,30,T6N,R10W)	L 1015

QUAD-YEAR	ELEV METER/FOOT	DESCRIPTION (INCLUDE QUAD AND YEAR IN DESCRIPTION)	BM NUMBER
LLANO (1998)	0819.308 2688.013	RDBM MON IN WELL 2M W/O PP (NO#) 10.7M N C/L PALMDALE BLVD & 38M W/O C/L 110TH ST E MKD 1960 MKR POST 600MM N/O MON	L 1022
LLANO (1998)	0821.868 2696.412	RDBM MON IN WELL 2M NE/O PP #4400358E 10M N/O C/L PALMDALE BLVD & 59M W/O C/L 115TH ST E (UNIMPROVED) MKD (1960) MKR POST 600MM N/O MON	L 1024
LLANO (1998)	0822.347 2697.983	RDBM MON IN WELL 2M NE/O PP #4400359E 10M N/O C/L PALMDALE BLVD & 76M E/O C/L 115TH ST E MKD 1960) MKR POST 600MM N/O MON	L 1025
LLANO (1998)	0825.432 2708.105	RDBM MON IN WELL 2M E/O PP #4400368E 10M N C/L PALMDALE BLVD & 27.4M W/O C/L 120TH ST E MKD (1960) MKR POST 600MM N/O MON	L 1026
LLANO (1998)	0829.112 2720.178	RDBM MON IN WELL 1M NE/O PP #4400379E 10M N/O C/L PALMDALE BLVD & 41M W/O C/L 125TH ST E (UNIMPROVED) MKD (1960)	L 1028
LLANO (1998)	0831.918 2729.384	RDBM MON 10M N/O C/L PALMDALE BLVD & 6M W/O C/L 130TH ST E 1.2M N/O PP #4400391E MKD (1961)	L 1030
LLANO (1998)	0836.095 2743.088	RDBM MON IN WELL 1.5M NW/O PP #1190811E 11M N C/L PALMDALE BLVD & 35M E/O C/L LONGVIEW RD MKD (1960) MKR POST 600MM N/O MON	L 1033
LLANO (1998)	0843.168 2766.294	RDBM MON IN WELL W/COVER 1M N/O PP #2174663E 10M N C/L PALMDALE BLVD 116M E/O C/L 145TH ST E MKR POST 600MM N/O MON	L 1037
LLANO (1998)	0848.304 2783.144	RDBM MON IN WELL 1.5M SE/O PP #672265H 10M S/O C/L PALMDALE BLVD & 38M W/O C/L 155TH ST E MKD (1960) MKR POST 600MM S/O MON	L 1040
LLANO (1998)	0848.749 2784.604	RDBM MON IN WELL 3M SW/O PP #585889H 10M S/O C/L PALMDALE BLVD & 107M E/O 155TH ST E MKD (1960) MKR POST 600MM S/O MON	L 1041
LLANO (1998)	0849.122 2785.828	RDBM MON IN WELL 3M NW/O PP #4191308E 10M N/O C/L PALMDALE BLVD 53.5M E/O C/L 160TH ST E (PROP) FROM N MKD (1960)	L 1043
LLANO (1998)	0850.247 2789.519	RDBM MON IN WELL 2M NW/O PP #1190886E 10M N C/L PALMDALE BLVD & 55M E/O C/L 165TH ST E MKD 1960 MKR POST 600MM S/O MON	L 1045
LLANO (1998)	0848.999 2785.424	RDBM MON IN WELL 2.4M NW/O PP #1190900E 10M N C/L PALMDALE BLVD 157M E/O 170TH ST E MKR POST 600MM S/O MON	L 1047

QUAD-YEAR	ELEV METER/FOOT	DESCRIPTION (INCLUDE QUAD AND YEAR IN DESCRIPTION)	BM NUMBER
LLANO (1998)	0847.273 2779.761	RDBM MON IN WELL 10M N/O C/L PALMDALE BLVD & 43M W/O C/L 175TH ST E (DIRT RD) MKR POST 600MM N/O MON	L 1048
LLANO (1998)	0844.938 2772.101	RDBM MON IN WELL W/COVER FL 2.4M SW/O PP (NO#) 12M W/O C/L 180TH ST E & 33.5M N/O C/L PALMDALE BLVD MKD (1961) MKR POST 600MM W/O MON	L 1051
LLANO (1998)	0837.961 2749.210	CS MON IN WELL 450MM DN @ C/L INT 180TH ST E & AVE Q MKD (SEC 23,22,26,27,T6N,R9W)	L 1052
LLANO (1998)	0837.840 2748.813	RDBM MON 2.4M N/O PP #BF90451 10.4M W C/L 180TH ST E & 14M N/O C/L AVE Q MKD (1961) MKR POST 600MM W/O MON	L 1053
LLANO (1998)	0830.804 2725.729	RDBM MON IN WELL 2M W/O PP #825775E 18M E/O C/L 180TH ST E & 10M N/O C/L AVE P-8 MKD (1961) MKR POST 600MM N/O MON	L 1055
LLANO (1998)	0825.801 2709.315	RDBM MON IN WELL 2M W/O PP (NO#) 11M W/O C/L 180TH ST E & 87M S/O AVE P MKD (1961) MKR POST 600MM W/O MON	L 1056
LLANO (1998)	0825.029 2706.783	USGS MON 100MM UP 10M W/O C/L 180TH ST E ON FUT AVE P MKD (LS 1 1929) 30.5M S/O PP #1875922E	L 1057
LLANO (1998)	0808.183 2651.514	CSBM MON 150MM UP @ SW COR 180TH ST E & AVE N-8 10M W & 38M S/O EXIST PVMT 1.5M N/O PP #767679E MKD (BM 106-85 1959) MKR POST 600MM E/O MON	L 1061
LLANO (1998)	0802.362 2632.416	CSBM MON 150MM UP 1.5M W/O PP #767685E 12M W & 10M N/O C/L INT 180TH ST E & AVE N MKD (BM 106-86 1959) MKR POST 600MM NW/O MON	L 1062
LLANO (1998)	0797.749 2617.282	CSBM MON 150MM UP 10M W/O C/L 180TH ST E & 9M N/O C/L FUT AVE M-8 MKD (BM 106-87 1959) MKR POST 600MM E/O MON	L 1063
BASELINE (1998)	0788.636 2587.383	CSBM MON FLUSH @ SW COR AVE M & 170TH ST E 38M S & 7M W/O C/L INT MKD (BM 106-90 1959) MKR POST ON W SIDE MON (BENT OVER)	L 1066
BASELINE (1998)	0785.880 2578.341	CS MON IN WELL 200MM DN @ C/L INT AVE M & 150TH ST E MKD (SEC COR 31,32,5,6,T6N,T7N,R9W)	L 1102
LLANO (1998)	0789.395 2589.873	CS MON IN WELL 600MM DN @ C/L INT 150TH ST E & AVE M-8 MKD (1/4 SEC 5,6,T6N,R9W)	L 1104
LLANO (1998)	0794.332 2606.071	CS MON IN WELL 700MM DN @ C/L INT 150TH ST E & AVE N MKD (5,6,7,8,T7N,R9W)	L 1107

QUAD-YEAR	ELEV METER/FOOT	DESCRIPTION (INCLUDE QUAD AND YEAR IN DESCRIPTION)	BM NUMBER
LLANO (1998)	0827.056 2713.433	RDBM MON 2.4M S/O PP (NO#) 10.7M E/O C/L 145TH ST E & 21.3M S/O C/L AVE O-8 (UNIMPROVED) MKD (1960) MKR POST 600MM E/O MON	L 1113
LLANO (1998)	0853.607 2800.542	CS MON 100MM DN @ C/L AVE P & 5M W/O C/L 145TH ST E MKD (1/4 SEC 18,19,T6N,R9W,RE 2177)	L 1114
LLANO (1998)	0845.797 2774.919	RDBM MON IN WELL W/COVER 10.7M E/O C/L 145TH ST E & 30.5M N/O C/L AVE P-8 (UNIMPROVED) MKD 1961 MKR POST 600MM E/O MON	L 1116
LLANO (1998)	0844.223 2769.755	RDBM MON IN WELL W/COVER 10.7M E/O C/L 145TH ST E & 30.5M S C/L AVE P-8 (UNIMPROVED) MKD (1960) MKR POST 600MM E/O MON	L 1117
LLANO (1998)	0836.983 2746.002	CSBM MON 13.7M W/O C/L 145TH ST E & 10.7M S/O C/L AVE Q 1M W/O PP #632132H MKD (BM Q145E)	L 1118
LLANO (1998)	0837.240 2746.845	RDBM MON IN WELL W/COVER 10.7M S/O C/L AVE Q & 72M E/O C/L 145TH ST E MKD (1961) MKR POST 600MM S/O MON	L 1119
LLANO (1998)	0850.020 2788.774	CS MON 450MM DN @ C/L INT AVE Q & 150TH ST E MKD (SEC 19,20,29,30,T6N,R9W)	L 1121
LLANO (1998)	0864.689 2836.900	L&BN IN CONC @ S GATE TO FARM 11M E C/L 165TH ST E & 2.7M N C/L PROP AVE R-8 1.6K S/O PALMDALE BLVD 6M N/O PP #325111E MKD (BM)	L 1125
LLANO (1998)	0871.958 2860.749	CS MON IN WELL 18IN DN @ C/L INT 165TH ST E & AVE S MKD (SEC 33,4,5,T5N,T6N,R9W)	L 1126
LLANO (1998)	0873.484 2865.755	RDBM MON IN WELL 13M E C/L 165TH ST E & 70M S/O C/L AVE S 6M E/O PP #325124E MKR 600MM E/O MON	L 1127
LLANO (1998)	0880.898 2890.080	RDBM MON IN WELL 13M E C/L 165TH ST E & 88M N/O AVE S-8 6M E/O PP #4312494 MKR 600MM W/O MON	L 1128
LLANO (1998)	0882.429 2895.102	RDBM MON IN WELL 13M E C/L 165TH ST E & 64M S/O C/L AVE S-8 6M E/O PP (NO#) 600MM W/O MON	L 1129
LLANO (1998)	0900.473 2954.302	RDBM MON IN WELL 11M E C/L 165TH ST E & 84M N/O C/L AVE T-8 17M S/O PP #1403611E MKR POST 600MM W/O MON	L 1132
LLANO (1998)	0902.889 2962.228	RDBM MON IN WELL 11M E C/L 165TH ST E & 62M S/O C/L AVE T-8 32M S/O PP #1403613E MKR 1M W/O MON	L 1133
LLANO (1998)	0913.636 2997.487	RDBM MON IN WELL 11M E C/L 165TH ST E & 84M N C/L AVE U 16M S/O PP #1403624E	L 1134

QUAD-YEAR	ELEV METER/FOOT	D E S C R I P T I O N (INCLUDE QUAD AND YEAR IN DESCRIPTION)	BM NUMBER
LLANO (1998)	0925.956 3037.907	RDBM TAG IN W LEG TRANS TOWER I 23-5 41M E/O C/L 165TH ST E & 203M N/O AVE U-8	L 1136
LLANO (1998)	0926.927 3041.093	RDBM MON IN WELL 11M E C/L 165TH ST E & 157M N AVE U-8 43M S/O TRANS LINE & 9M SW PP #1403636E	L 1137
LLANO (1998)	0944.674 3099.318	RDBM MON IN WELL 11M E C/L 165TH ST E & 82M N C/L AVE V 26M S/O PP (NO#) MKR 600MM E/O MON	L 1138
BASELINE (1998)	0794.206 2605.658	CSBM MON 150MM UP @ NE COR 90TH ST E & AVE P 9M N & 20.7M E/O C/L INT MKD (BM 107-12 1960)	L 1188
BASELINE (1998)	0801.886 2630.854	CS MON IN WELL 200MM DN @ C/L INT 90TH ST E & AVE Q MKD (SEC COR 19,20,29,30,R10W,T6N) NOTE: MON WAS RAISED AUG 1987	L 1191
BASELINE (1998)	0806.888 2647.265	CSBM MON FL @ NW COR 90TH ST E & PALMDALE BLVD 10M N & 20M W/O C/L INT MKD (BM 107-9 1960)	L 1193
LLANO (1998)	0936.004 3070.873	CS MON IN WELL 200MM DN @ C/L INT 123RD ST E & AVE V-10 MKD (CO SUR RE 63)	L 1196
LLANO (1998)	0943.756 3096.306	L&T IN SE COR CONC WK TO CHURCH BLDG 9.4M W/O C/L 123RD ST E & 27.4M N/O C/L AVE V-12	L 1197
LLANO (1998)	0944.658 3099.265	CS MON IN WELL 200MM DN @ C/L INT 123RD ST E & AVE V-12 MKD (CO SURV RE 63)	L 1198
LLANO (1998)	1029.900 3378.930	RDBM MON IN WELL @ NW COR 121ST ST E & AVE W-8 14.3M N & 13.7M W/O C/L INT MKD (1961) MKR POST 600MM W/O MON	L 1203
LLANO (1998)	1030.176 3379.836	RDBM MON IN WELL @ SE COR 121ST ST E & AVE W-8 18M S & 10.7M E/O C/L INT MKD (1961) MKR POST 600MM E/O MON	L 1204
BASELINE (1998)	0899.188 2950.086	CSBM MON 100MM UP @ SE COR PEARBLOSSOM HWY & 96TH ST E 9.4M S & 54M E/O C/L INT MKD (BM 106 -22 1958)	L 1205
BASELINE (1998)	0901.402 2957.350	CSBM MON 150MM UP 12M S/O C/L PEARBLOSSOM HWY & 672M W/O 106TH ST E 15M W/O CTR SMALL WASH MKD (BM 106-23 1958)	L 1206
LLANO (1998)	1163.545 3817.397	RDBM MON IN WELL 4M N/O BARB WIRE FENCE 10M S/O C/L PALLETT CREEK RD 161M E/O POWER LINE CROSS 805M E/O LONGVIEW RD MKR POST 600MM S/O MON	L 1385

QUAD-YEAR	ELEV METER/FOOT	DESCRIPTION (INCLUDE QUAD AND YEAR IN DESCRIPTION)	BM NUMBER
LLANO (1998)	1161.588 3810.977	RDBM MON IN WELL 1M N/O BARB WIRE FENCE 13.4M S/O C/L PALLETT CREEK RD 805M E/O LONGVIEW RD MKD (1961) MKR POST 600MM S/O MON	L 1386
LLANO (1998)	1131.984 3713.851	RDBM MON IN WELL 200MM DN 11.3M N/O C/L PALLETT CREEK RD 1.8K NE/O LONGVIEW RD MKD (1961) MKR POST 600MM N/O MON 52M W/O MI MKR #1.07	L 1388
LLANO (1998)	1096.286 3596.732	RDBM MON IN WELL 200MM DN 10M S/O C/L PALLETT CREEK RD 2.9K NE/O LONGVIEW RD 805M SW VALYERMO RD 16M W/O MI MKR #1.67 MKD (1961) MKR POST 600MM S/O MON	L 1389
LLANO (1998)	1096.325 3596.860	RDBM MON IN WELL 200MM DN 10M N/O C/L PALLETT CR RD 2.9K NE/O LONGVIEW RD 805M SW/O VALYERMO RD 32M E/O MI MKR #1.67 MKD (1961) MKR POST 600MM N/O MON	L 1390
LLANO (1998)	1082.386 3551.128	L&BN IN CONC ABUT @ SW END BRIDGE B213 5M S/O C/L VALYERMO RD & 61M E/O PALLETT CREEK RD	L 1392
LLANO (1998)	1082.394 3551.154	L&BN IN CONC ABUT @ SE END BRIDGE B213 5M S/O C/L VALYERMO RD 79M E/O PALLETT CREEK RD	L 1393
LLANO (1998)	1098.651 3604.491	RDBM TAG IN SE COR CONC DR TO EX FIRE STA 7.6M N C/L VALYERMO RD & 805M E/O PALLETT CREEK RD	L 1395
LLANO (1998)	1108.439 3636.604	RDBM TAG IN SW END BRIDGE WINGWALL #1025 4.6M S C/L VALYERMO RD & 1.3K E/O PALLETT CREEK RD	L 1396
LLANO (1998)	1108.482 3636.745	RDBM TAG IN NE END BRIDGE WINGWALL #1025 5.5M N C/L VALYERMO RD & 1.3K E/O PALLETT CREEK RD	L 1397
LLANO (1998)	1131.403 3711.945	RDBM TAG IN 1ST STEP TO BLDG #3 US RANGER STA 35M S C/L VALYERMO RD & 85M E/O C/L 157TH ST E	L 1398
LLANO (1998)	1161.678 3811.272	CS MON 200MM UP 24M N C/L VALYERMO RD & 1K E/O 157TH ST E MKD (1/4 SEC COR 8,17,T4N,R9W) ON FENCE LINE 29M ELY FROM FENCE COR	L 1399
LLANO (1998)	1162.689 3814.589	RDBM MON IN WELL 35M N C/L VALYERMO RD & 1K E/O 157TH ST E 8.2M S/O PP (NO#) MKR 600MM N/O MON	L 1400
LLANO (1998)	1187.750 3896.810	USGS MON IN NE COR ABUT OF BRIDGE 490 4.6M N & 4.6M W/O C/L INT VALYERMO RD & BOBS GAP RD MKD (LS 56 1929 RESET 1960)	L 1401

QUAD-YEAR	ELEV METER/FOOT	DESCRIPTION (INCLUDE QUAD AND YEAR IN DESCRIPTION)	BM NUMBER
LLANO (1998)	1174.429 3853.106	CS MON IN WELL 150MM DN ON C/L BOBS GAP RD 563M N/O VALYERMO RD 116M S/O RD TO MOUNTAIN BROOK RANCH & 28M S/O PP (NO#) MKD (SEC COR 8,9,17,16, T4N,R9W)	L 1404
LLANO (1998)	1158.311 3800.225	RDBM MON IN WELL 18M E/O C/L BOBS GAP RD & 1.4K N/O VALYERMO RD 20M S/O C/L DIRT DR TO FARM HSE 600MM N/O BARB WIRE FENCE	L 1405
LLANO (1998)	1161.600 3811.016	RDBM MON IN WELL 10M W/O C/L BOBS GAP RD & 1.4K N/O VALYERMO RD 32M N/O C/L DIRT RD TO FARM HSE MKR POST 600MM W/O MON	L 1406
LLANO (1998)	1225.009 4019.050	RDBM TAG IN CONC FTG 2IN IP NR FENCE COR 13.4M S/O C/L BOBS GAP RD & 2.5K E/O VALYERMO RD 14M E/O C/L DIRT RD TO RANCH #17120	L 1408
LLANO (1998)	1233.205 4045.940	RDBM MON IN WELL 12M S/O C/L BOBS GAP RD & 11M W/O C/L PANORAMA RD (PVT) MKR POST 600MM S/O MON	L 1409
LLANO (1998)	1124.665 3689.838	RDBM TAG IN SE COR OF CONC BOX INLET @ CULV # 2.33 6M N C/L BOBS GAP RD & 3.6K NE VALYERMO RD	L 1410
LLANO (1998)	1192.862 3913.581	RDBM TAG 1.2M N/O S END ROCK WALL 5.5M E/O C/L BOBS GAP RD & 3K SE/O 165TH ST E	L 1411
LLANO (1998)	1190.697 3906.478	RDBM TAG 54M N/O S END ROCK WALL 5.5M E/O C/L BOBS GAP RD & 3K SE/O 165TH ST E	L 1412
LLANO (1998)	1149.492 3771.292	RDBM MON IN WELL 12.5M S/O C/L BOBS GAP RD & 1.9K SE/O 165TH ST E MKR POST 600MM S/O MON	L 1413
LLANO (1998)	1147.214 3763.818	RDBM MON IN WELL 8M N/O C/L BOBS GAP RD & 1.9K SE/O 165TH ST E MKR POST 600MM N/O MON	L 1414
LLANO (1998)	1068.403 3505.252	BN IN CONC BASE STONE PILLAR @ FORMER ENT TO CRYSTALAIR COUNTRY CLUB 2.4M W/O C/L PROD 165TH ST E & 43M SW/O C/L BOBS GAP RD	L 1417
LLANO (1998)	1014.693 3329.039	RDBM MON IN WELL 8.5M E C/L 165TH ST E & 59M S C/L AVE W-8 1M NE/O PP #4143398E MKR 600MM E MON	L 1421
LLANO (1998)	1011.969 3320.102	CS MON IN WELL @ C/L INT 165TH ST E & AVE W-8 MKD (1/4 SEC COR 29,28,T5N,R9W)	L 1422
LLANO (1998)	0986.945 3238.002	CS MON IN WELL @ C/L INT 165TH ST E & AVE W (PROP) 805M S/O PEARBLOSSOM HWY MKD (T5N,R9W, SEC COR 20,21,29,28)	L 1423

JAD-YEAR	ELEV METER/FOOT	D E S C R I P T I O N (INCLUDE QUAD AND YEAR IN DESCRIPTION)	BM NUMBER
LLANO (1998)	0986.238 3235.683	RDBM TAG IN NE COR OF CONC SLAB IN FRONT OF OLD HSE FOUNDATION 24.4M W C/L 165TH ST E & 41M N/O C/L AVE W (PROP) 805M S/O PEARBLOSSOM HWY	L 1424
LLANO (1998)	1198.689 3932.699	RDBM MON IN WELL 200MM DN 15M S & 12M W/O C/L INT BIG ROCK CREEK RD & BIG PINES HWY 2M W/O PP (NO#)	L 1881
LLANO (1998)	1235.255 4052.666	RDBM MON IN WELL 200MM DN 25M W/O C/L DRWY TO HSE #16820 BIG PINES HWY 9M S/O C/L & 966M E/O C/L BIG ROCK CREEK RD MKR POST 600MM S/O MON	L 1884
LLANO (1998)	1286.758 4221.639	RDBM MON IN WELL 200MM DN 8M S/O C/L BIG PINES HWY & 1.6K E/O BIG ROCK CREEK RD 42M W/O MI MKR 1.01 MKD (1963) MKR POST 600MM S/O MON	L 1887
LLANO (1998)	1337.870 4389.328	L&T IN LGE ROCK 8.5M N/O C/L BIG PINES HWY & & 2.4K E/O C/L BIG ROCK CREEK RD @ END OF SLOPE CUT MKD (BM)	L 1888
LLANO (1998)	1342.505 4404.535	RDBM MON IN WELL 7.6M S/O C/L BIG PINES HWY & 2.5K E/O INT BIG ROCK CREEK RD MKD (1963) MKR POST 600MM S/O MON	L 1889
LLANO (1998)	1379.771 4526.799	USGS MON 150MM UP 9M N/O C/L BIG PINES HWY & 3.1K E/O BIG ROCK CREEK RD ON SMALL RIDGE MKD (LS 57 1929) MKR POST 600MM S/O MON	L 1890
LLANO (1998)	1419.266 4656.375	RDBM MON IN WELL 7.3M S/O C/L BIG PINES HWY & & 3.9K E/O C/L BIG ROCK CREEK RD 61M E/O MI MKR #2.40 MKD (1963) MKR POST 600MM S/O MON	L 1893
LLANO (1998)	1452.508 4765.437	RDBM MON IN WELL 12M S/O C/L BIG PINES HWY & 4.7K E/O C/L BIG ROCK CREEK RD 47M W/O MI MKR #2.90 MKR POST 600MM S/O MON	L 1895
LLANO (1998)	1535.461 5037.592	RDBM MON IN WELL 200MM DN 9M SW/O C/L BIG PINES HWY & 5.8K E/O BIG ROCK CREEK RD 23M W/O MI MKR #3.62 MKR 600MM S/O MON 2.1K W/O LARGO VISTA RD	L 1897
LLANO (1998)	1566.139 5138.241	RDBM TAG IN CONC BOX 5.5M S C/L BIG PINES HWY & 6K E/O BIG ROCK CREEK RD 1.7K W/O LARGO VISTA RD NR MI MKR #3.84	L 1899
LLANO (1998)	1578.847 5179.934	RDBM MON IN WELL 200MM DN 18M N/O C/L BIG PINES HWY & 6.4K E/O BIG ROCK CREEK RD 1.3K W/O LARGO VISTA RD MKD (1965) MKR POST 600MM S/O MON	L 1901
LLANO (1998)	1585.949 5203.234	L&T IN W END CONC GAS ISLAND 11M N & 122M W/O C/L INT BIG PINES HWY & LARGO VISTA RD MKD (BM)	L 1904

QUAD-YEAR	ELEV METER/FOOT	DESCRIPTION (INCLUDE QUAD AND YEAR IN DESCRIPTION)	BM NUMBER
BASELINE (1998)	1591.062 5220.009	USC&GS MON 100MM UP @ NW COR BIG PINES HWY & LARGO VISTA RD 9M N & 10M W/O APPROX C/L INT MKD (F 1166 1962)	L 1905
LLANO (1998)	1476.664 4844.688	USC&GS MON FLUSH IN VERT FACE OF WALL @ S END FOUNDATION OF OLD MILL 15M W/O C/L LARGO VISTA RD & 1.3K N/O BIG PINES HWY 110M S/O MILE MKR #28.33 MKD (E 1167 1962)	L 1911
LLANO (1998)	1344.823 4412.140	L&BN IN CONC FTG OF S GATE POST TO FOREST RD PANORAMA MOTORWAY 21M E/O C/L LARGO VISTA RD & 3.7K N/O BIG PINES HWY MKD (BM) 3.2K S/O FORT TEJON RD	L 1919
LLANO (1998)	1332.213 4370.769	USC&GS MON FLUSH IN LGE BOULDER 9M W C/L LARGO VISTA RD & 3.9K N BIG PINES HWY 2.9K S/O LARGO VISTA RD MKD (C1167 1962) MKR SIGN 300MM E MON	L 1921
LLANO (1998)	1313.966 4310.903	RDBM MON IN WELL 200MM DN 12M E C/L LARGO VISTA RD & 4.2K N/O BIG PINES HWY ON C/L PROD PANORAMA MTY (DIRT) 2.6K S FORT TEJON RD MKR 600MM E MON	L 1922
LLANO (1998)	1289.679 4231.222	40MM IP 300MM UP 8.5M W C/L LARGO VISTA RD & 4.7K N/O BIG PINES HWY 18M N/O PP #X5016E 2.1K S/O FORT TEJON RD MKR POST 600MM E/O MON	L 1925
LLANO (1998)	1265.036 4150.372	USC&GS MON 125MM UP @ SW COR LARGO VISTA RD & AVE Z-2 6M S & 17M W/O C/L INT MKD (E 1166 1962) MKR POST 150MM E/O MON 5.2K N/O BIG PINES HWY	L 1926
LLANO (1998)	1222.695 4011.459	40MM IP FLUSH 9M E/O APPROX C/L LARGO VISTA RD & 805M S/O FT TEJON RD ON C/L AVE Y-8 11M N/O DIRT RD	L 1929
LLANO (1998)	1181.247 3875.475	USC&GS MON FLUSH @ SE COR LARGO VISTA RD & FORT TEJON RD 11M S & 18M E C/L INT MKD (LARGO 1940) MKR POST 450MM E/O MON	L 1932
LLANO (1998)	1155.384 3790.622	USGS MON 150MM UP 21M W LARGO VISTA RD 5M N/O OLD FT TEJON RD 483M N/O FT TEJON RD MKD (LS 65 1929) MKR POST 300MM W/O MON	L 1934
LLANO (1998)	1140.968 3743.326	RDBM MON IN WELL 200MM DN @ SW COR LARGO VISTA RD & FUTURE AVE X-8 14M S & 20M W/O APPROX C/L INT 30M S/O MI MKR #24.48 MKD (BM 2-1963) MKR POST 600MM W/O MON	L 1936
LLANO (1998)	1102.114 3615.852	RDBM MON IN WELL 200MM DN @ SW COR LARGO VISTA RD & FUTURE AVE X 9M S & 15M W/O APPROX C/L INT MKR SIGN 600MM S/O MON	L 1939

QUAD-YEAR	ELEV METER/FOOT	DESCRIPTION (INCLUDE QUAD AND YEAR IN DESCRIPTION)	BM NUMBER
BASELINE (1998)	0785.958 2578.597	CSBM MON 300MM DN @ NE COR AVE M & 150TH ST E 16M N & 10M E/O C/L INT MKD (BM 115-11 1961) MKR POST 600MM W/O MON	L 2049
BASELINE (1998)	0785.974 2578.650	CS MON IN WELL @ C/L INT AVE M & FUT 155TH ST E MKD (1/4 SEC COR 32,5,T6N,T7N,R9W)	L 2050
BASELINE (1998)	0787.078 2582.272	50MM IP W/NAIL 200MM UP @ NE COR AVE M & FUT 155TH ST E 15MN & 15M E/O C/L INT (USE E EDGE)	L 2051
BASELINE (1998)	0786.293 2579.696	50MM IP W/NAIL 200MM UP @ SW COR AVE M & FUT 160TH ST E 15M S & 15M W/O C/L INT (USE W EDGE)	L 2052
BASELINE (1998)	0786.403 2580.057	50MM IP W/NAIL 200MM UP @ NE COR AVE M & FUT 160TH ST E 15M N & 15M E/O C/L INT (USE E EDGE)	L 2053
BASELINE (1998)	0786.629 2580.799	50MM IP W/NAIL FLUSH @ SW COR AVE M & FUT 165TH ST E 15M S & 15M W/O C/L INT	L 2054
BASELINE (1998)	0786.698 2581.025	50MM IP W/NAIL 150MM UP @ NE COR AVE M & FUT 165TH ST E 15M N & 15M E/O C/L INT (USE S EDGE)	L 2055
BASELINE (1998)	0888.910 2916.366	RDBM TAG N CB 1.2M E/O BCR @ NE COR 87TH ST E & PEARBLOSSOM HWY 24M E & 12.2M N/O C/L INT	L 2666
BASELINE (1998)	0894.763 2935.568	RDBM TAG IN CTR HDWL 7.3M S/O C/L PEARBLOSSOM HWY & 805M E/O 87TH ST E 14.6M E/O PP #543955H	L 2667
BASELINE (1998)	0899.731 2951.867	L&BN IN E EDGE CONC PAD @ TELE RELAY STA #9550 PEARBLOSSOM HWY 20.4M S/O C/L & 32M W/O C/L 96TH ST E	L 2669
LLANO (1998)	0894.226 2933.806	RDBM MON IN WELL 200MM DN @ NE COR 116TH ST E & AVE U-8 9M E & 182M N/O C/L INT 1.5M N/O PP #1062441E MKR POST 600MM N/O MON	L 2673
LLANO (1998)	0965.496 3167.631	L&BN IN NW ABUT OF BRIDGE #53-313 5.5M N/O C/L PEARBLOSSOM HWY & 1.13K W/O 165TH ST E	L 2682
LLANO (1998)	0975.916 3201.818	USC&GS MON 150MM E/O W EDGE HDWL @ SE COR 175TH ST E & PEARBLOSSOM HWY 9M S & 15M E/O C/L INT MKD (Z 1045 1960)	L 2685
LLANO (1998)	1001.459 3285.620	USC&GS TRI MON 150MM UP 14M S & 37M E/O C/L INT PEARBLOSSOM HWY & AVE W 2M S/O PP #1404430E MKD (CURVE 1964) MKR POST 600MM E/O MON	L 2687
LLANO (1998)	1001.110 3284.475	USC&GS REF MON 150MM E/O W END HDWL OF CULV 11.4M S & 70M E/O C/L INT PEARBLOSSOM HWY & AVE W MKD (CURVE NO 1 1964)	L 2688

QUAD-YEAR	ELEV METER/FOOT	DESCRIPTION (INCLUDE QUAD AND YEAR IN DESCRIPTION)	BM NUMBER
LLANO (1998)	1032.513 3387.503	RDBM MON IN WELL @ NW COR PALMDALE RD & 233RD ST E 10.4M W & 67M N/O C/L INT 1M W PP #777984E	L 2692
LLANO (1998)	0892.604 2928.485	CS MON IN WELL 400MM DN @ C/L INT PALMDALE BLVD & 235TH ST E MKD (CTR SEC 27,T6N,R8W,RE 5869)	L 2695
LLANO (1998)	0819.536 2688.761	CSBM MON 150MM UP 12M E/O 180TH ST E & NR LAKE LOS ANGELES AVE C/L PROD MKD (BM 114-7 1961)	L 2696
LLANO (1998)	0831.255 2727.209	CSBM MON 150MM UP @ SE COR 180TH ST E & FUT AVE P-8 11M E & 7.6M S/O C/L INT MKD (BM 114-5 1961) MKR POST 600MM W/O MON	L 2697
LLANO (1998)	0838.066 2749.555	CSBM MON 150MM UP @ NW COR 180TH ST E & AVE Q 15M N & 11M W/O C/L INT MKD (BM 114-4 1961) MKR POST 600MM E/O MON	L 2698
LLANO (1998)	0845.522 2774.017	CSBM MON FL @ NW COR PALMDALE BLVD & 180TH ST E 15.5M N & 16.5M W/O C/L INT MKD (BM 114-3 1961) MKR POST 600MM S/O MON	L 2699
BASELINE (1998)	0789.822 2591.274	CSBM MON FL @ NE COR 150TH ST E & FUT AVE M-8 23M N & 10.4M E/O C/L INT MKD (BM 115-10 1961) MKR POST 600MM E/O MON	L 2700
BASELINE (1998)	0794.811 2607.642	CSBM MON 150MM UP @ NE COR AVE N & 150TH ST E 20M N & 9M E/O C/L INT MKD (BM 115-9 1961) MKR POST 600MM E/O MON	L 2701
BASELINE (1998)	0798.414 2619.463	CSBM MON 150MM UP @ NW COR 150TH ST E & FUT AVE N-8 57M N & 10M W/O C/L INT MKD (BM 115-8 1961) MKR POST 600MM W/O MON	L 2702
BASELINE (1998)	0808.070 2651.143	CSBM MON 150MM UP @ SW COR AVE O & 145TH ST E 30.5M S & 11.3M W/O C/L INT MKD (BM 115-6 1961) MKR POST 600MM W/O MON	L 2704
LLANO (1998)	0824.902 2706.366	CSBM MON 150MM UP @ NE COR 145TH ST E & FUT AVE O-8 36.6M N & 7.6M E/O C/L INT MKD (BM 115-5 1961) MKR POST 600MM E/O MON	L 2705
LLANO (1998)	0854.140 2802.291	CSBM MON 150MM UP 8.5M W/O C/L 145TH ST E & 24.4M N/O C/L FUT AVE P MKD (BM 115-4 1961)	L 2706
LLANO (1998)	0848.502 2783.794	CSBM MON 150MM UP 11.6M E/O C/L 145TH ST E & 139M N/O FUT AVE P-8 MKD (BM 115-3 1961) MKR POST 600MM W/O MON	L 2707

JAD-YEAR	ELEV METER/FOOT	DESCRIPTION (INCLUDE QUAD AND YEAR IN DESCRIPTION)	BM NUMBER
LLANO (1998)	0836.634 2744.857	CSBM MON 150MM UP @ NE COR AVE Q & 145TH ST E 22.3M N & 12.2M E/O C/L INT MKD (BM 115-2 1961) MKR POST 600MM W/O MON	L 2708
LLANO (1998)	0849.714 2787.770	CSBM MON FLUSH @ SE COR 150TH ST E & AVE Q 9.4M E & 30.5M S/O C/L INT MKD (BM 115-1A 1966) MKR POST 600MM S/O MON	L 2709
LLANO (1998)	0846.100 2775.913	CSBM MON 150MM UP @ NE COR PALMDALE BLVD & 150 TH ST E 15M N & 7.6M E/O C/L INT MKD (BM 109-12 1961) MKR POST 600MM S/O MON	L 2710
LLANO (1998)	0814.819 2673.285	50MM IP W/CONC PLUG & N IN WELL 250MM DN @ C/L INT AVE O & FUTURE 185FT ST E	L 2714
LLANO (1998)	0820.007 2690.306	CSBM MON 150MM UP @ SE COR PALMDALE BL & 110TH ST E 28M E & 11.6M S C/L INT MKD (BM 109-4 1961) MKR POST 600MM N/O MON	L 2716
LLANO (1998)	0826.641 2712.071	CSBM MON 450MM UP @ SE COR PALMDALE BLVD & FUT 120TH ST E 39M E & 11.3M S/O C/L INT MKD (BM 109-6 1961)	L 2717
LLANO (1998)	0848.692 2784.417	CSBM MON 150MM UP @ SW COR PALMDALE BL & 155TH ST E 9.4M S & 6M W/O C/L INT MKD (BM 109-1 1961)	L 2720
LLANO (1998)	0847.601 2780.838	CS MON IN WELL 300MM DN @ C/L INT PALMDALE BLVD & 175TH ST E MKD (CTR SEC 27, T6N, R9W)	L 2723
LLANO (1998)	0847.527 2780.595	RDBM MON IN WELL 150MM DN 2.4M S/O PP #1218033E 11M S/O C/L PALMDALE BLVD ON C/L FUR 185TH ST E	L 2724
LLANO (1998)	0854.192 2802.462	50MM IP & CE TAG FLUSH @ NE COR PALMDALE BLVD & FUT 190TH ST E 15M N & 15M E/O C/L INT	L 2725
LLANO (1998)	0858.055 2815.135	RDBM MON 75MM DN @ SE COR PALMDALE BLVD & FUT 195TH ST E 2M S/O PP #1218058E 12M S & 13.7M E/O C/L INT MKD (1961) MKR POST 600MM S/O MON	L 2726
LLANO (1998)	0861.045 2824.945	50MM IP & CE TAG 100MM DN @ NE COR PALMDALE BLVD & 200TH ST E 15M N & 15M E/O C/L INT MKR POST 300MM N/O MON	L 2727
LLANO (1998)	0865.664 2840.099	L&BR IN CONC GARAGE APRON @ NW COR PALMDALE BL & 205TH ST E 69M N & 15M W/O C/L INT MKD (BM)	L 2728
LLANO (1998)	0875.421 2872.110	RDBM MON IN WELL FLUSH @ SE COR PALMDALE BLVD & FUT 215TH ST E 2.3M S/O PP #1218108E 10.7M S & 46M E/O C/L INT MKR 600MM S/O MON	L 2730

QUAD-YEAR	ELEV METER/FOOT	DESCRIPTION (INCLUDE QUAD AND YEAR IN DESCRIPTION)	BM NUMBER
LLANO (1998)	0885.213 2904.236	50MM IP & NAIL @ NE COR PALMDALE BLVD & FUT 220TH ST E 15M N & 15M E/O C/L INT 32.6M W/O PP #1218120E	L 2731
LLANO (1998)	0883.094 2897.284	RDBM MON IN WELL 150MM DN @ SE COR PALMDALE BL & FUT 225TH ST E 10.4M S & 13M E/O C/L INT 2M S/O PP #1218132E MKR POST 1M S/O MON	L 2732
LLANO (1998)	1080.312 3544.324	USC&GS MON IN SE WINGWALL BRIDGE B980 5.5M E C/L LONGVIEW RD & 76M N/O C/L FT TEJON FROM E MKD (RADELL 1964)	L 2735
LLANO (1998)	1170.959 3841.721	CSBM BM MON 13M S/O C/L PALLETT CREEK RD & 322M E/O LONGVIEW RD MKD (CR-10 RE 5869) MKR 600MM E 20M E/O PP #2293983E	L 2736
LLANO (1998)	1149.815 3772.351	CSBM MON 100MM UP 11M S/O C/L PALLETT CREEK RD & 1.2K E/O LONGVIEW RD MKD (CR-11 RE 5869) MKR POST 600MM E/O MON	L 2737
LLANO (1998)	1132.317 3714.943	L&T IN NE COR CONC SLAB 7.6M S/O C/L VALYERMO RD & 123M E/O 157TH ST E	L 2739
LLANO (1998)	1187.731 3896.747	PK NAIL IN SW COR OF BRIDGE 38M W/O C/L BOBS GAP RD & 4.6M S/O C/L VALYERMO RD	L 2740
LLANO (1998)	0948.782 3112.796	CSBM MON 150MM UP @ SW COR 165TH ST E & PROP AVE V 64M S & 10.4M W/O C/L INT MKD (BM 109-24 1961) MKR POST 600MM W/O MON	L 2741
LLANO (1998)	0929.639 3049.991	CSBM MON 150MM UP @ NW COR 165TH ST E & PROP AVE U-8 37M N & 11.3M W/O C/L INT MKD (BM 109-23 1961) MKR POST 600MM E/O MON	L 2742
LLANO (1998)	0915.878 3004.843	CSBM MON 150MM UP @ SW COR 165TH ST E & PROP AVE U 11.3M W & 14M S/O C/L INT MKD (BM 109-22 1961) MKR POST 600MM E/O MON	L 2743
LLANO (1998)	0901.477 2957.596	CSBM MON 150MM UP @ NW COR 165TH ST E & AVE T-8 41M N & 12M W/O C/L INT MKD (BM 109-21 1961) MKR POST 600MM W/O MON	L 2744
LLANO (1998)	0881.515 2892.104	CSBM MON FLUSH @ NE COR 165TH ST E & PROP AVE S-8 13M E & 50M N/O C/L INT MKD (BM 109-19 1961) MKR POST 600MM W/O MON	L 2746
LLANO (1998)	0865.605 2839.906	CSBM MON 150MM UP @ SE COR 165TH ST E & AVE R-8 69M S & 8.5M E/O C/L INT MKD (BM 109-17 1961) MKR POST 600MM E/O MON	L 2748

QUAD-YEAR	ELEV METER/FOOT	DESCRIPTION (INCLUDE QUAD AND YEAR IN DESCRIPTION)	BM NUMBER
BASELINE (1998)	0859.434 2819.660	50MM IP CONC PLUG & TAG FL IN SE COR PUMP STA @ NE COR 87TH ST E & AVE T-8 45M E & 9M N C/L INT	L 2750
BASELINE (1998)	0858.782 2817.521	RDBM TAG IN CONC FENCE FTG @ NW COR PUMP STA @ NE COR 87TH ST E & AVE T-8 38M N & 11M E C/L INT	L 2751
BASELINE (1998)	0836.934 2745.841	CS MON IN WELL 3M W/O C/L 87TH ST E ON C/L AVE S-8 MKD (1/4 COR 1,6,T5N,R11W)	L 2753
BASELINE (1998)	0827.610 2715.250	RDBM TAG IN LT STD @ NE COR 90TH ST E & AVE S 55.5M N & 15.5M E/O C/L INT	L 2754
LLANO (1998)	0992.496 3256.214	CS MON IN WELL 200MM DN @ C/L INT LONGVIEW RD & AVE W-8 MKD (CTR SEC 26,R10W,T5N)	L 2764
LLANO (1998)	1029.898 3378.924	CS MON IN WELL 250MM DN @ C/L INT LONGVIEW RD & PROP AVE X MKD (1/4 COR 26,35,T5N,R10W,RE5869) 6.7M NE/O PP #462103E	L 2766
BASELINE (1998)	1025.346 3363.989	CS MON IN WELL 300MM DN @ C/L 106TH ST E & 805M S/O FT TEJON RD MKD (28,29,32,33,T5N,R10W)	L 2813
BASELINE (1998)	1026.759 3368.625	50MM IP 15M S & 15M W/O CS MON ON 106TH ST E 805M S/O FT TEJON RD	L 2814
LLANO (1998)	1069.502 3508.858	USGS MON FLUSH 9M E/O C/L 106TH ST E & 1.8K S/O FT TEJON RD 300MM N/O PP (NO#) MKD (R99 1929)	L 2815
LLANO (1998)	1073.996 3523.602	USC&GS MON 150MM UP 5.5M E/O C/L 106TH ST E & 1.9K S/O FT TEJON RD 600MM S/O PP #1185703E MKD (RIFT 1964)	L 2816
LLANO (1998)	1119.526 3672.978	RDBM MON IN WELL FLUSH 20M E/O C/L 106TH ST E & 2.7K S/O FT TEJON RD 1.5M S/O PP (NO#) 23M S/O DIRT RD MKR POST 600MM E/O MON	L 2817
LLANO (1998)	1122.360 3682.276	RDBM MON IN WELL FLUSH 17M E/O C/L 106TH ST E & 2.7M S/O FT TEJON RD 7.6M N/O C/L DIRT RD TO THE E 1.5M N/O PP (NO#) MKR POST 600MM E/O MON	L 2818
LLANO (1998)	1198.406 3931.770	RDBM MON IN WELL 200MM DN 8.2M E C/L 106TH ST E & 9M N/O C/L ROSS RD (DIRT PVT) @ MAIL BOX #10735 MKR POST 600MM E/O MON	L 2819
LLANO (1998)	1254.611 4116.170	RDBM MON IN WELL 200MM DN 10.4M E/O C/L 106TH ST E & 22M S/O C/L RAINBOW ACRES RD (PVT) 1.8M S/O PP (NO#) MKR POST 600MM E/O MON	L 2821

QUAD-YEAR	ELEV METER/FOOT	DESCRIPTION (INCLUDE QUAD AND YEAR IN DESCRIPTION)	BM NUMBER
LLANO (1998)	1258.897 4130.231	RDBM MON IN WELL 200MM DN 11M E/O C/L 106TH ST E 84M S/O C/L RAINBOW ACRES RD (PVT) 1.5M S/O PP #699206E MKR POST 600MM E/O MON	L 2822
LLANO (1998)	1306.239 4285.552	50MM IP W/CONC PLUG & CE TAG 150MM UP @ NW COR CIMA MESA RD & 106TH ST E 15M N & 15M W/O C/L INT	L 2823
LLANO (1998)	1333.319 4374.397	L&T IN SW COR CONC DRWY TO HSE #29806 JUNIPER HILLS RD 3M W/O SW COR OF GARAGE 8.5M E/O C/L 106TH ST E	L 2825
LLANO (1998)	1335.057 4380.100	RDBM TAG IN SE COR CONC PAD 8M E/O WATER TANK 29M W/O C/L JUNIPER HILLS RD & 106TH ST E OPP HSE #29806	L 2826
LLANO (1998)	1398.821 4589.299	RDBM MON IN WELL 150MM DN 9M E/O C/L JUNIPER HILLS RD & 1K SE/O 106TH ST E 1.2M N/O PP #PS 1545 MKD (BM 961) MKR POST 600MM E/O MON	L 2827
LLANO (1998)	1426.690 4680.732	RDBM TAG IN CONC BASE WATER TANK 7M S/O C/L JUNIPER HILLS RD & 73M E/O C/L DR TO HSE #11628	L 2830
LLANO (1998)	1429.358 4689.485	RDBM TAG @ NE COR CONC STANDPIPE BASE 7.6M N/O C/L JUNIPER HILLS RD & 1.6K W/O LONGVIEW RD 5M NW/O PP #1028228H	L 2831
LLANO (1998)	1430.434 4693.016	RDBM TAG IN CONC FTG OF W GATEPOST HSE #11882 JUNIPER HILLS RD 9M S C/L & 1.6K W LONGVIEW RD	L 2832
LLANO (1998)	1375.858 4513.961	RDBM MON IN WELL 200MM DN 14M N/O C/L JUNIPER HILLS RD & 110M W/O C/L 125TH ST E 1.5M W/O PP (NO#) MKR POST 600MM N/O MON	L 2833
LLANO (1998)	1366.743 4484.056	RDBM MON IN WELL 150MM DN 14M N/O C/L JUNIPER HILLS RD & 5.5M W/O C/L 125TH ST E 1.5M W/O PP (NO#) MKR POST 600MM N/O MON	L 2834
LLANO (1998)	1338.457 4391.254	RDBM MON IN WELL 150MM DN 44M W & 12M N/O C/L INT JUNIPER HILLS RD & LONGVIEW RD 1.5M E/O PP #699023E MKR POST 600MM N/O MON	L 2835
LLANO (1998)	1339.607 4395.027	RDBM TAG IN CONC FTG OF E GATEPOST 8.5M E & 2.4M S/O C/L INT JUNIPER HILLS RD & LONGVIEW RD	L 2836
LLANO (1998)	0960.575 3151.486	L&T IN N CB 300MM E/O BCR @ NE COR AVE V-14 & 121ST ST E 17.4M E & 6M N/O C/L INT MKD (BM)	L 2839
LLANO (1998)	0944.001 3097.110	RDBM TAG IN N CB 1M W/O END @ NW COR AVE V-14 & 123RD ST E 47M W & 6M N/O C/L INT	L 2840

QUAD-YEAR	ELEV METER/FOOT	DESCRIPTION (INCLUDE QUAD AND YEAR IN DESCRIPTION)	BM NUMBER
LLANO (1998)	0851.020 2792.055	50MM IP WITH CE TAG 100MM UP @ SE COR 116TH ST E & AVE S-8 26.5M S & 12M E/O C/L INT 7.6M N/O PP #618599H	L 2862
LLANO (1998)	0866.499 2842.839	50MM IP WITH CE TAG 100MM UP @ C/L PROD FUT AVE T-8 15M W/O C/L 116TH ST E 17M N/O PP (NO#) 322M S/O SPRR TRACKS	L 2866
LLANO (1998)	0881.055 2890.595	CS MON IN WELL 200MM DN @ C/L INT 116TH ST E & PROP AVE U MKD (9,10,16,15,R10W,T5N)	L 2868
BASELINE (1998)	0817.267 2681.317	CS MON 100MM DN @ C/L INT AVE M & 200TH ST E MKD (SEC COR 36,31,1,6,T7N,R9W,R8W)	L 3186
BASELINE (1998)	0817.585 2682.360	50MM IP W/CE TAG @ SW COR AVE M & 200TH ST E 14M S & 15.5M W/O C/L INT (S EDGE)	L 3187
BASELINE (1998)	0813.437 2668.751	40MM IP W/NAIL 100MM DN @ C/L INT AVE M & FUT 195TH ST E	L 3188
BASELINE (1998)	0813.490 2668.925	CHIS X ON N EDGE 40MM IP W/CE TAG 150MM UP ON C/L PROD FUT 195TH ST E & 15M S/O C/L AVE M	L 3189
BASELINE (1998)	0808.770 2653.440	CS MON 150MM DN @ C/L INT FUT AVE M & 190TH ST E MKD (SEC COR 35,36,2,1,T6N,T7N,R9W)	L 3190
BASELINE (1998)	0809.069 2654.421	CHIS X ON W EDGE 50MM IP W/CE TAG 150MM UP @ NW COR FUT AVE M & 190TH ST E 15M N & 15M W/O C/L INT	L 3191
BASELINE (1998)	0801.091 2628.246	50MM IP W/NAIL 150MM DN @ C/L INT FUT AVE M & FUT 185TH ST E	L 3192
BASELINE (1998)	0802.176 2631.806	CHIS X ON S EDGE 50MM IP W/CE TAG 100MM UP ON C/L PROD FUT 185TH ST E & 15M S/O C/L FUT AVE M	L 3193
BASELINE (1998)	0791.533 2596.888	50MM IP W/CE TAG 150MM UP ON C/L FUT 175TH ST E & 15M S/O C/L AVE M	L 3195
BASELINE (1998)	0789.027 2588.666	50MM IP W/CS TAG @ SE COR AVE M & 170TH ST E 15M S & 15M E/O C/L INT MKR POST 600MM W/O MON	L 3342
BASELINE (1998)	0823.557 2701.953	40MM IP W/NAIL 150MM DN @ C/L INT FUT AVE M & 205TH ST E	L 3393
BASELINE (1998)	0823.924 2703.157	50MM IP W/CE TAG 150MM UP ON C/L 205TH ST E & 15M S/O C/L FUT AVE M	L 3394
BASELINE (1998)	0829.534 2721.563	50MM IP W/CE TAG 200MM UP @ SW COR FUT AVE M & 210TH ST E 15M S & 15M W/O C/L INT	L 3395

QUAD-YEAR	ELEV METER/FOOT	DESCRIPTION (INCLUDE QUAD AND YEAR IN DESCRIPTION)	BM NUMBER
BASELINE (1998)	0829.118 2720.198	CS MON 300MM DN @ C/L INT FUT AVE M & 210TH ST E MKD (SEC COR 31,32,6,5,T6N,R8W)	L 3396
BASELINE (1998)	0833.674 2735.145	50MM IP W/CE TAG 200MM UP @ SW COR FUT AVE M & 215TH ST E 15M S & 15M W/O C/L INT	L 3397
BASELINE (1998)	0833.525 2734.657	40MM IP W/NAIL 300MM DN @ C/L INT FUT AVE M & 215TH ST E	L 3398
BASELINE (1998)	0840.599 2757.865	50MM IP W/CE TAG 150MM UP @ NE COR FUT AVE M & 220TH ST E 15MN & 15M E/O C/L INT	L 3400
BASELINE (1998)	0852.108 2795.624	50MM IP W/CE TAG 200MM UP @ SW COR FUT AVE M & 230TH ST E 15M S & 15M W/O C/L INT MKR POST 300MM W/O MON	L 3403
BASELINE (1998)	0851.836 2794.732	CS MON 150MM DN @ C/L INT FUT AVE M & 230TH ST E MKD (SEC COR 33,34,3,4,T6N,R8W) MKR POST 300MM S/O MON	L 3404
BASELINE (1998)	0863.199 2832.012	50MM IP W/CE TAG 250MM UP @ SW COR FUT AVE M & 235TH ST E 15M S & 15M W/O C/L INT MKR POST 300MM S/O MON	L 3405
BASELINE (1998)	0868.589 2849.696	50MM IP W/CE TAG 150MM UP @ SW COR 240TH ST E & FUT AVE M 15M S & 15M E/O C/L INT MKR POST 300MM E/O MON	L 3407
BASELINE (1998)	0868.250 2848.584	CS MON IN WELL 300MM DN @ C/L INT FUT AVE M & 240TH ST E MKD (SEC COR 2,3,34,35,T6N,R8W)	L 3408
LLANO (1998)	0817.689 2682.701	CSBM MON FL @ SW COR FUT 200TH ST E & FUT AVE M-8 4.6M S & 12M W C/L INT MKD (BM 124-26 1966) MKR POST 600MM N/O MON	L 3535
LLANO (1998)	0817.206 2681.117	CS MON 300MM DN @ C/L INT FUT AVE N & 200TH ST E MKD (SEC COR 1,6,7,12,T6N,R8W,R9W) MKR POST 600MM N/O MON	L 3536
LLANO (1998)	0821.972 2696.753	CS MON 250MM DN @ C/L INT FUT AVE N-8 & 200TH ST E MKD (1/4 COR 7,12,T6N,R8W,R9W,RE 5869) MKR POST 600MM N/O MON	L 3537
LLANO (1998)	0886.378 2908.058	CS MON IN WELL 300MM DN @ C/L INT 240TH ST E & FUTURE AVE M-8 MKD (1/4 COR 2,3,T6N,R8W)	L 3538
LLANO (1998)	0903.582 2964.502	CS MON IN WELL 400MM DN @ C/L INT 240TH ST E & FUTURE AVE N MKD (2,3,10,11,T6N,R8W)	L 3539

QUAD-YEAR	ELEV METER/FOOT	DESCRIPTION (INCLUDE QUAD AND YEAR IN DESCRIPTION)	BM NUMBER
LLANO (1998)	0886.406 2908.150	CS MON 300MM DN @ C/L INT FUT 240TH ST E & AVE N-8 MKD (1/4 COR 10,11,T6N,R8W)	L 3540
LLANO (1998)	0875.021 2870.798	S MON IN WELL 300MM DN @ C/L INT 240TH ST E & AVE P MKD (15,14,22,23,T6N,R8W,RE 5869)	L 3561
LLANO (1998)	0879.887 2886.763	40MM IP & NAIL IN WELL 400M DN @ C/L INT AVE P & FUT 245TH ST E	L 3562
LLANO (1998)	0880.480 2888.708	50MM IP & LACS TAG 100MM UP @ NE COR AVE P & FUT 245TH ST E 15M E/O & 15M N/O C/L INT MKR POST 300MM S/O MON	L 3563
LLANO (1998)	0884.858 2903.072	CS MON IN WELL 450MM DN @ C/L INT AVE P & FUT 250TH ST E MKD (14,13,23,24,T6N,R8W)	L 3565
LLANO (1998)	0887.748 2912.553	50MM IP & NAIL IN WELL 300MM DN @ C/L INT AVE P & FUT 255TH ST E 11M NE/O PP #1634698E	L 3566
LLANO (1998)	0888.640 2915.480	50MM IP & CS TAG FL @ SE COR AVE P & FUT 255TH ST E 15M S & 15M E/O C/L INT MKR 300MM N/O MON	L 3567
LLANO (1998)	0889.133 2917.097	50MM IP & CE TAG FL @ NW COR AVE P & 260TH ST E 15M N & 15M W/O C/L INT MKR POST 6M E/O MON	L 3568
LLANO (1998)	0889.300 2917.645	CS MON IN WELL (SLY MON) 250MM DN @ C/L INT AVE & 260TH ST E MKD (13,18,24,19,T6N,R8W,T7N)	L 3569
LLANO (1998)	1170.044 3838.719	CS MON IN WELL 200MM DN ON C/L FT TEJON RD 805M E/O C/L LARGO VISTA RD MKD (1/4 SEC COR 31,6, T5N,T4N,R8W)	L 3573
LLANO (1998)	1170.889 3841.492	40MM IP W/PLUG & NAIL 8.5M S/O APPROX C/L FT TEJON RD & 805M E/O LARGO VISTA RD 300MM E/O PP #665359E	L 3574
LLANO (1998)	1162.402 3813.647	RDBM TAG IN CONC FTG FENCE POST 3M W/O FENCE COR @ SW COR FT TEJON RD & 213TH ST E 9M S & 11.6M W/O C/L INT	L 3575
LLANO (1998)	1161.175 3809.622	CS MON 300MM DN @ C/L INT FT TEJON RD & 213TH ST E (MKD T5N,T4N,R8W,COR SEC 31,32,6,5)	L 3576
LLANO (1998)	1158.253 3800.035	CS MON FLUSH 7.6M N/O C/L FT TEJON RD & 1.2K E/O 213TH ST E 21M W/O PP #665379E MKD (MESCAL CREEK) MKR POST 600MM S/O MON	L 3579
LLANO (1998)	1150.873 3775.822	50MM IP PLUG & RDBM TAG 75MM UP 15M W/O 223TH ST E (FROM THE S) & 10.7M N/O C/L FT TEJON RD	L 3581

QUAD-YEAR	ELEV METER/FOOT	DESCRIPTION (INCLUDE QUAD AND YEAR IN DESCRIPTION)	BM NUMBER
LLANO (1998)	1148.276 3767.302	USGS BR CAP MON 150MM UP 7M S/O APPROX C/L FT TEJON RD & 0.1MI E/O 223RD ST E 300MM S/O PP (NO#) MKD (BM DATUM S-13)	L 3583
LLANO (1998)	1083.010 3553.175	50MM IP WITH CE TAG 150MM UP 77M N & 10M W/O APPROX C/L INT 233RD ST E & ANTELOPE HWY MKR POST 600MM E/O MON	L 3590
LLANO (1998)	1059.323 3475.462	BR ROD IN CONC BASE @ NE COR ACCESS RD P/L FOR CAL AQUADUCT 6M E/O C/L 233RD ST E & 644M N/O ANTELOPE HWY (MKD M6-177-A DWR R/W) ANGLE IRON MKR POST 300MM W/O MON	L 3592
LLANO (1998)	1056.195 3465.200	CS BR MON FLUSH ON SEC LINE N SIDE OF AQUADUCT 805M S/O PALMDALE RD ON C/L 233RD ST E 13.5M SE/O PP #1875842E MKD (1/4 COR 28/27 1982) RESET MKR POST 600MM W/O MON	L 3593
BASELINE (1998)	0793.749 2604.158	CS MON IN WELL 450MM DN @ C/L INT AVE P & 90TH ST E MKD (17,18,19,20,T6N,R10W)	L 4080
BASELINE (1998)	0802.134 2631.668	CSBM MOB FL 17.4M E & 8.2M N/O C/L INT AVE Q & 90TH ST E MKD (BM 107-10 1966)	L 4081
LLANO (1998)	0929.389 3049.170	RDBM TAG IN CONC WK NR NW COR OF BLDG 21M S & 15M E/O C/L INT PEARBLOSSOM HWY & 123RD ST E	L 4085
LLANO (1998)	0985.491 3233.232	RDBM TAG IN CONC HDWL OF CULV 6.4M S/O C/L PEARBLOSSOM HWY & 644M ELY/O 175TH ST E	L 4086
LLANO (1998)	1038.894 3408.438	50MM IP W/CONC PLUG & N 150MM UP 15M N & 14.6M W/O C/L INT PEARBLOSSOM HWY & LARGO VISTA RD 2M N/O PP #1373751E MKR POST 600MM N/O MON	L 4087
LLANO (1998)	0961.540 3154.652	RDBM TAG IN NE LEG OF EDISON TOWER #23-4 9M W/O C/L 235TH ST E 322M N/O AVE U NLY OF TWO TOWERS	L 4089
LLANO (1998)	0880.863 2889.965	CHIZ X ON N EDGE OF 50MM IP/CONC PLUG & CE TAG 125M UP 15M S & 15M W/O C/L INT 240TH ST E & AVE P-8 (DIRT) MKR POST 300MM W/O MON	L 4127
LLANO (1998)	0868.034 2847.875	CSBM MON 125MM UP 11M N/O C/L AVE O & 120M W/O C/L 240TH ST E 2M E/O PP #734996E MKD (BM 106- 71A 1972) MKR POST 600MM S/O MON	L 4128
LLANO (1998)	0886.577 2908.711	CSBM MON 125MM UP 18M E & 18M S/O C/L INT 240TH ST E & AVE N-8 (DIRT) MKD (BM 124-57A 1972) MKR POST 600MM W/O MON (BUTTON GONE)	L 4130

QUAD-YEAR	ELEV METER/FOOT	DESCRIPTION (INCLUDE QUAD AND YEAR IN DESCRIPTION)	BM NUMBER
LLANO (1998)	0870.266 2855.198	50MM IP W/CONC PLUG & NAIL 14.3M W & 15M N/O C/L INT PALMDALE BLVD & 210TH ST E MKR POST 450MM N/O MON	L 4133
LLANO (1998)	0888.272 2914.272	50MM IP W/CONC PLUG & CE TAG 15M W & 15M S/O C/L INT PALMDALE BLVD & 230TH ST E	L 4134
LLANO (1998)	0812.863 2666.868	40MM IP W/CONC PLUG & BRAD FL 15M N & 15M W/O C/L INT 180TH ST E & AVE O PP #1875925E 6.6M E/O MON	L 4135
BASELINE (1998)	0794.549 2606.783	RDBM TAG IN ROCK & CONC HDWL 4.6M W/O C/L 180TH ST E (DIRT) & 30.5M S/O C/L AVE M (DIRT)	L 4136
LLANO (1998)	0818.766 2686.235	50MM IP W/CONC PLUG & CE TAG 300MM UP 15M S C/L AVE O & 1.6K E/O 180TH ST E MKR 600MM N/O MON	L 4137
LLANO (1998)	0826.958 2713.111	CS MON IN WELL 480MM DN @ C/L INT AVE O & 200TH ST E 15M E/O DIRT RD FROM S 40M W/O W SIDE HSE #20111 MKD (SEC COR 12,7,13,18,T6N,R8W,R9W)	L 4138
LLANO (1998)	0899.513 2951.152	STATE OF CAL DEPT OF WATER RESOURCES BM MON IN CONC CB 4.6M N/O CTR OF BRIDGE #B1638 4.6M W/O C/L 116TH ST E & 106M N/O AVE U-8	L 4141
LLANO (1998)	0881.667 2892.602	RDBM TAG IN NE COR CONC SLAB @ FIRE HYDRANT 23M W & 13.4M S/O C/L INT 116TH ST E & AVE U	L 4143
BASELINE (1998)	0996.075 3267.956	CS MON IN WELL 100MM DN @ C/L INT FT TEJON RD & 106TH ST E MKD (1/4 COR 28,29,R10W,T5N RE 7078)	L 4144
LLANO (1998)	1527.253 5010.663	RDBM TAG IN S END OF ROCK & CONC HDWL 9M E C/L LARGO VISTA RD & 805M N/O BIG PINES RD @ MI MKR #28.75	L 4146
LLANO (1998)	1467.223 4813.714	RDBM TAG IN S END CONC HDWL 7.3M W/O C/L LARGO VISTA RD & 1.5K N/O BIG PINES HWY 6M S/O MI MKR #28.33 & 5.3K S/O FT TEJON RD	L 4147
LLANO (1998)	1407.438 4617.570	RDBM MON IN WELL 200MM DN 9M E C/L LARGO VISTA RD & 2.6K N/O BIG PINES HWY 4.2K S/O FORT TEJON RD 35M S/O GUY POLE MKD (1963) MKR 600MM E/O MON	L 4149
LLANO (1998)	1380.655 4529.699	RDBM MON IN WELL 15M E/O C/L LARGO VISTA RD & 3K N/O BIG PINES HWY 6M S/O CONC WELL BOX & OPP DIRT DR 33.5M S/O MI MKR #27.28 MKR 600MM W MON 3.7K S/O FORT TEJON RD	L 4150

QUAD-YEAR	ELEV METER/FOOT	DESCRIPTION (INCLUDE QUAD AND YEAR IN DESCRIPTION)	BM NUMBER
LLANO (1998)	1306.046 4284.919	50MM IP W/CONC PLUG & LS TAG #2568 12M E C/L LARGO VISTA RD & 4.4K N/O BIG PINES HWY 7.6M N/O PP #X-5013E 3M S/O C/L AVE Z-8 DIRT RD MKR POST 600MM W/O MON	L 4151
LLANO (1998)	1263.881 4146.583	50MM IP W/CONC PLUG & CE TAG 200MM UP 15M W & 15M N/O C/L INT LARGO VISTA RD & AVE Z-2 DIRT 5.1K N/O BIG PINES HWY MKR POST 600MM E/O MON	L 4152
LLANO (1998)	1181.320 3875.714	CE TAG IN ROCK & CONC WINGWALL 10M S & 14M W/O C/L LARGO VISTA RD & FT TEJON RD @ MKR #25.00	L 4153
LLANO (1998)	1101.012 3612.237	CS MON IN WELL 450MM DN @ C/L INT LARGO VISTA RD & AVE X (PROP) 1.6K S/O PEARBLOSSOM HWY MKD (SEC COR 25,36,30,31,R8W,R9W,T5N)	L 4154
LLANO (1998)	1063.315 3488.559	USC&GS MON IN CONC WALK @ SE COR BRIDGE #B1643 OVER THE CALIF AQUADUCT 5M E/O C/L LARGO VISTA RD & 805M S/O PEARBLOSSOM HWY MKD (S 1220 1971)	L 4155
LLANO (1998)	1062.436 3485.675	DWR MON IN CONC WALK @ NW COR BRIDGE #1643 OVER THE CALIF AQUEDUCT 4.6M W/O C/L LARGO VISTA RD & 805M S PEARBLOSSOM HWY MKD (371.7A RESET 1971)	L 4156
LLANO (1998)	1046.869 3434.603	BR CAP MON 9M W/O C/L LONGVIEW RD & 6M N/O C/L AC RD TO AQUEDUCT 483M S/O AVE X-3 MKD M-6 35 1971) MKR POST 600MM SE/O MON	L 4159
LLANO (1998)	1069.386 3508.477	50MM IP W/CONC PLUG & CE TAG FLUSH 15M N & 15M W/O C/L INT LONGVIEW RD TO N & FT TEJON RD MKR POST 300MM S/O MON	L 4160
LLANO (1998)	1071.381 3515.022	50MM IP W/CONC PLUG & CE TAG 15M S/O C/L FT TEJON RD ON C/L PROD LONGVIEW RD (FROM THE N)	L 4161
LLANO (1998)	1084.225 3557.162	RDBM MON IN WELL 200MM DN 64M S & 11.6M W/O C/L INT LONGVIEW RD TO S & FT TEJON RD MKD (1960) MKR POST 600MM W/O MON	L 4162
LLANO (1998)	0960.338 3150.709	L&T IN E CB 300MM N/O BCR @ NE COR 121ST ST E & AVE V-14 14M N & 9M E/O C/L INT MKD (73)	L 4163
LLANO (1998)	1064.390 3492.086	DWR BM MON IN CONC WALK @ NW END OF BRIDGE #B1639 OVER AQUEDUCT 4.6M W C/L 121ST ST E & 241M N/O FT TEJON RD MKD (362 6A RESET 1971)	L 4164
LLANO (1998)	1064.257 3491.650	SPK IN CONC CB @ SE COR BRIDGE #B1639 OVER CAL AQUEDUCT 4.6M E/O C/L 121ST ST E & 241M N/O FT TEJON RD	L 4165

QUAD-YEAR	ELEV METER/FOOT	DESCRIPTION (INCLUDE QUAD AND YEAR IN DESCRIPTION)	BM NUMBER
BASELINE (1998)	0845.080 2772.567	50MM IP W/CONC PLUG & 45 CARTRIDGE 200MM UP 15M S & 15M E/O C/L INT AVE O & FUT 135TH ST E 11M NE/O PP #1786912E	L 4167
BASELINE (1998)	0836.877 2745.654	50MM IP W/CONC PLUG & CE TAG 100MM DN 15M S & 15M E/O C/L INT AVE O & FUT 125TH ST E	L 4170
BASELINE (1998)	0838.190 2749.962	50MM IP 200MM UP 15M N & 15M W/O C/L INT AVE O & FUT 125TH ST E	L 4171
BASELINE (1998)	0815.320 2674.929	50MM IP W/CONC PLUG FLUSH 15M N & 15M E/O C/L INT AVE O & FUT 120TH ST E MKR 300MM N/O MON	L 4172
BASELINE (1998)	0791.885 2598.043	40MM IP W/CONC PLUG & BRAD FL 15M N & 15M E/O C/L INT AVE O & 105TH ST E CHIS X ON W EDGE MKR POST 300MM N/O MON	L 4176
BASELINE (1998)	0792.352 2599.575	40MM IP W/CONC PLUG & BRAD FL 15M S & 15M W/O C/L INT AVE O & 105TH ST E 13M E/O PP #2287760E	L 4177
BASELINE (1998)	0789.612 2590.585	50MM IP W/CONC PLUG & BRAD 12M N & 12M W/O C/L INT AVE O & 100TH ST E 6.4M W/O PP #2145389E	L 4179
LLANO (1998)	0813.622 2669.358	L&T IN N CB 300MM W/O BCR @ NW COR PALMDALE BLVD & 100TH ST E 13M N & 23M W/O C/L INT	L 4849
LLANO (1998)	0842.839 2765.214	RDBM TAG 600MM E/O END OF CONC STRIP 724M E/O 140TH ST E & 4M N/O PALMDALE BLVD 4.3M S/O PP #1190834E	L 4850
LLANO (1998)	0870.307 2855.332	CS MON IN WELL 400MM DN @ C/L INT PALMDALE BLVD & 210TH ST E MKD (1/4 SEC COR 29,30,T6N,R8W,RE 2177)	L 4851
LLANO (1998)	0856.970 2811.576	50MM IP WITH CS TAG IN WELL 250MM DN @ C/L INT 165TH ST E & AVE R	L 4852
LLANO (1998)	1063.144 3487.998	L&T IN W CB 2.4M S/O BCR @ SW COR CRYSTALAIRE DR & 165TH ST E 12M W & 21M S/O C/L INT	L 4854
LLANO (1998)	0931.231 3055.214	L&T IN W CB 300MM S/O BCR @ SW COR PEARBLOSSOM HWY & LONGVIEW RD 13M W & 24M S/O C/L INT	L 4855
LLANO (1998)	0824.743 2705.844	RDBM TAG CTR OF N EDGE WATER DIST VAULT 23M N & 8M W/O C/L INT 110TH ST E & AVE R	L 4856
LLANO (1998)	0842.909 2765.444	RDBM MON IN WELL @ NW COR AVE S & 116TH ST E 15M N & 14M W/O INT 2M N/O PP #4118684E	L 4857

QUAD-YEAR	ELEV METER/FOOT	DESCRIPTION (INCLUDE QUAD AND YEAR IN DESCRIPTION)	BM NUMBER
LLANO (1998)	0843.143 2766.212	50MM IP W/CONC PLUG & CE TAG 150MM UP @ NE COR AVE S & 116TH ST E 19M N & 12M E/O INT TRAV RDS	L 4858
LLANO (1998)	0850.661 2790.877	CS MON 300MM DN @ C/L INT 116TH ST E & AVE S-8 MKD (1/4COR 4,8,T5N,R10W) 26.5M S/O INT DIRT RDS	L 4859
LLANO (1998)	0857.889 2814.591	RDBM MON IN WELL @ NW COR 116TH ST E & AVE T 15M N & 24.4M W/O C/L INT 3M N/O PP #1121798E	L 4860
LLANO (1998)	1001.921 3287.136	RDBM MON IN WELL 200MM DN 805M E/O 106TH ST E & 18M S/O C/L FT TEJON RD 21M W/O MI MKR #3.35 MKR POST 600MM N/O MON	L 4862
LLANO (1998)	1154.778 3788.634	RDBM MON IN WELL 805M E/O 213TH ST E & 13M S/O FT TEJON RD 2.4M S/O PP #665375E MKD (1982) MKR POST 600MM S/O MON	L 4863
LLANO (1998)	0936.138 3071.313	RDBM MON IN WELL 13.4M E/O C/L 235TH ST E 1.9K N/O AVE U S/O DIRT RD FR SE MKD (1982) MKR POST 300MM S/O MON	L 4864
LLANO (1998)	0894.910 2936.051	RDBM MON IN WELL @ SE COR PALMDALE BLVD & 240TH ST E 9M S & 11.6M E/O C/L INT 2M E PP #1309785E MKD (1984) MKR POST 600MM N/O MON	L 4865
LLANO (1998)	0888.014 2913.426	50MM IP W/CONC PLUG & LACS TAG @ SW COR 240TH ST E & AVE Q 15M S & 15M W/O C/L INT 8.5M S/O FENCE LINE MKR POST 300MM W/O MON	L 4866
LLANO (1998)	0870.326 2855.395	50MM IP W/CONC PLUG & LACS TAG 200MM UP @ SE COR 240TH ST E & AVE O-8 15M S & 15M E/O C/L INT 48M S/O PP #735802E MKR POST 1M E/O MON	L 4867
LLANO (1998)	0869.815 2853.718	40MM IP W/CONC PLUG & BRAD 450MM DN IN WELL @ C/L INT 240TH ST E & AVE O-8 33M S PP #735802E	L 4868
LLANO (1998)	0869.059 2851.238	RDBM MON IN WELL @ SW COR 240TH ST E & AVE O 11M S & 13.7M W/O C/L INT MKD (1984) MKR POST 600MM W/O MON	L 4869
LLANO (1998)	0903.715 2964.938	50MM IP W/CONC PLUG & LACS TAG 3IN UP @ SW COR 240TH ST E & AVE N 12M S & 12M W/O C/L INT MKR POST 300MM W/O MON	L 4870
LLANO (1998)	0887.241 2910.890	50MM IP W/CONC PLUG & LACS TAG 100MM UP @ SE COR 240TH ST E & M-8 15M S & 15M E/O C/L INT (E EDGE) MKR POST 300MM E/O MON	L 4871
LLANO (1998)	0797.866 2617.665	50MM IP CONC PLUG & LACS TAG 200MM UP @ SW COR 180TH ST E & AVE M-8 15M W & 21.3M S/O C/L INT	L 4872

QUAD-YEAR	ELEV METER/FOOT	DESCRIPTION (INCLUDE QUAD AND YEAR IN DESCRIPTION)	BM NUMBER
LLANO (1998)	0801.747 2630.398	CS MON 300MM DN @ C/L INT 180TH ST E & AVE N 29M NE/O PP (NO#) & 13M SE/O PP (NO#) MKD (CO SURV 2,3,10,11,T6N,R9W)	L 4873
LLANO (1998)	0807.884 2650.533	50MM IP W/CONC PLUG & CS TAG 150MM UP @ NW COR 180TH ST E & AVE N-8 15M N & 15M W/O C/L INT 1.2M SE/O FENCE LINE	L 4874
LLANO (1998)	0817.755 2682.918	50MM IP W/CONC PLUG & NAIL 150MM UP @ C/L INT 200TH ST E & AVE M-8 MKR POST 13M SW/O MON	L 4875
LLANO (1998)	0817.698 2682.731	50MM IP CONC PLUG & LACS TAG 200MM UP @ NE COR 200TH ST E & AVE N 12M N & 12M E/O C/L INT	L 4876
LLANO (1998)	0822.210 2697.534	50MM IP CONC PLUG & LACS TAG 200MM UP @ NW COR 200TH ST E & AVE N-8 15M N & 15M W/O C/L INT MKR POST 300MM N/O MON	L 4877
LLANO (1998)	0850.097 2789.027	CS MON IN WELL DN 300MM @ C/L INT 165TH ST E & PALMDALE BLVD MKD (RE 5869)	L 4878
LLANO (1998)	0885.797 2906.152	50MM IP & CS TAG 200MM DN 15M S & 15M E/O C/L INT AVE P & FUT 250TH ST E MKR 300MM E/O MON	L 4879
LLANO (1998)	0808.977 2654.119	RDBM TAG 300MM E/O W END CONC BOX 82M E & 7.6M S/O C/L INT AVE O & 160TH ST E	L 4880
LLANO (1998)	0805.664 2643.249	CS TAG TOP BRIDGE RAILING @ SE COR BRIDGE #93 13M W & 6M S/O C/L INT AVE O & 165TH ST E	L 4881
LLANO (1998)	0821.231 2694.322	50MM IP W/CONC PLUG & NAIL IN WELL DN 650MM @ C/L INT AVE O & 195TH ST E (DIRT RD)	L 4883
LLANO (1998)	0831.460 2727.882	40MM IP W/CONC PLUG & NAIL DN 500MM IN WELL @ C/L INT AVE O & 205TH ST E 6M E/O DIRT RD TO S 14.6M SW/O PP #2003618	L 4884
LLANO (1998)	0840.675 2758.115	40MM IP W/CONC PLUG & NAIL DN 450MM IN WELL @ C/L INT AVE O & 215TH ST E (DIRT RD TO N) 31M W/O PP #734968E	L 4885
LLANO (1998)	0844.948 2772.134	50MM IP W/CONC PLUG & NAIL 100MM UP 15M W & 15M N C/L INT AVE O & 220TH ST E 26M W/O PP 734973E	L 4886
LLANO (1998)	0850.171 2789.269	50MM IP W/PLUG & CS TAG 200MM UP 15M S & 15M E/O C/L INT AVE O & 225TH ST E 55M W/O PP (NO#)	L 4887
LLANO (1998)	0854.720 2804.194	50MM IP W/CONC PLUG & LACS TAG 250MM UP 15M S & 15M W/O C/L INT AVE O & 230TH ST E 66.5M W/O PP (NO#)	L 4888

QUAD-YEAR	ELEV METER/FOOT	DESCRIPTION (INCLUDE QUAD AND YEAR IN DESCRIPTION)	BM NUMBER
LLANO (1998)	0862.451 2829.558	50MM IP W/CONC PLUG & LACS TAG 250MM UP 15M N & 15M E/O C/L INT AVE O & 235TH ST E 15M NE/O PP #734991E	L 4889
BASELINE (1998)	0889.209 2917.347	CSBM MON IN E END C B 21M E/O BCR @ NE COR 87TH ST E & PEARBLOSSOM HWY 43M E & 12.5M N/O C/L INT MKD (BM 106-20A 1966 RE 5869)	L 5178
BASELINE (1998)	0847.918 2781.878	DPW BM TAG IN E CB 3.4M S/O BCR @ SE COR AVE T & 87TH ST E 28.3M S & 12.8M E/O C/L INT	L 5179
BASELINE (1998)	0837.477 2747.622	DPW BM TAG IN N END CONC HDWL 84M S & 7.3M W/O C/L 87TH ST E & AVE S-8 @ MI MKR #19.71	L 5180
BASELINE (1998)	0819.601 2688.974	DPW BM TAG IN CB 300MM S/O END @ SE COR 90TH ST E & AVE R-8 19M E & 9.4M S/O C/L INT	L 5181
BASELINE (1998)	0813.134 2667.757	DPW BM TAG IN NW COR CONC DRWY TO HSE #9006 AVE R 12.2M S/O C/L & 42M E/O C/L 90TH ST E	L 5182
BASELINE (1998)	0798.588 2620.034	DPW BM TAG IN TOP OF W SIDE CONC BREATHER PIPE @ SE COR AVE P-8 & 90TH ST E 18M E & 6M S/O C/L INT 26M E/O PP #1103851E	L 5183
BASELINE (1998)	0904.153 2966.375	CS MON IN WELL 300MM DN @ C/L INT 106TH ST E & PEARBLOSSOM HWY MKD (1994 RE 11915)	L 5521
BASELINE (1998)	0901.105 2956.375	DPW BM TAG IN CTR HDWL 6.6M S/O C/L PEARBLOSSOM HWY & 422M W/O C/L 106TH ST E	L 5522
BASELINE (1998)	0900.043 2952.891	DPW BM TAG IN CTR HDWL 7.6M S/O C/L PEARBLOSSOM HWY & 729M E/O C/L 96TH ST E	L 5523
BASELINE (1998)	0892.104 2926.845	CAL-TRANS TAG IN N CB PEARBLOSSOM HWY 12.7M N/O C/L & 9.4M W/O C/L 89TH ST E	L 5524
BASELINE (1998)	0827.826 2715.959	DPW BM TAG IN SW COR CONC F HYD PAD @ NE COR 90TH ST E & AVE S 29M E & 13M N/O C/L INT	L 5525
BASELINE (1998)	0796.898 2614.490	CS MON IN WELL 600MM DN @ C/L INT 90TH ST E & AVE P-8	L 5527
BASELINE (1998)	0785.675 2577.669	CS MON IN WELL 500MM DN @ C/L INT 90TH ST E & AVE O	L 5528
LLANO (1998)	0858.236 2815.729	DPW BM TAG IN W CONC HDWL @ SE COR 116TH ST E & AVE T 12M S & 10M E/O C/L INT	L 5824

JAD-YEAR	ELEV METER/FOOT	D E S C R I P T I O N (INCLUDE QUAD AND YEAR IN DESCRIPTION)	BM NUMBER
LLANO (1998)	0919.991 3018.337	50MM IP W/CONC PLUG & DPW TAG 750MM ELY/O NELY PROP COR HSE #11000 PEARBLOSSOM HWY 15.5M WLY & 805M SLY/O 106TH ST E	L 5825
LLANO (1998)	0925.465 3036.296	40MM IP W/CONC & BRAD @ SW COR PERABLOSSOM HWY & AVE V 16M S & 17.4M W/O C/L INT MKR POST 300MM N/O MON	L 5826
LLANO (1998)	0936.929 3073.908	DPW BM TAG IN CONC ELEC BOX PAD @ NW COR 116TH ST E & PEARBLOSSOM HWY 38M N & 8.2M W/O C/L INT	L 5827
LLANO (1998)	0936.878 3073.741	L&BN IN WLY END OF CONC HDWL @ NE COR 116TH ST E & PEARBLOSSOM HWY 23.5M N & 21M E/O C/L INT	L 5828
LLANO (1998)	0931.540 3056.227	DPW BM TAG IN NW COR CONC F HYD PAD @ NE COR 121ST ST E & PEARBLOSSOM HWY 16M E & 11.5M S/O C/L INT	L 5829
LLANO (1998)	0929.237 3048.672	DPW BM TAG 1.2M S SLY CF IN C B @ SW COR 123RD ST & PEARBLOSSOM HWY 14M S & 17M W/O C/L INT	L 5830
LLANO (1998)	0930.143 3051.644	DPW BM TAG IN S CB @ E END C B SE COR 126TH ST E & PEARBLOSSOM HWY 13M S & 17.4M E/O C/L INT	L 5831
LLANO (1998)	0931.170 3055.014	DPW BM TAG IN E END HDWL 15M E/O C/L PROD LONGVIEW RD & 14.3M N/O C/L PEARBLOSSOM HWY	L 5832
LLANO (1998)	0961.264 3153.747	25MM IP W/DIV HWYS TAG 24M S/O C/L PEARBLOSSOM HWY & 2.5K E/O 131ST ST E MKR 300MM S/O MON	L 5833
LLANO (1998)	0964.106 3163.071	CS MON FL 15.4M S/O C/L PEARBLOSSOM HWY 166M E/O TP STUB #31 & 2.8K E/O 131ST ST E MKD (PROP LINE 1983 RE 22726) MKR 300MM SE/O MON	L 5834
LLANO (1998)	0965.748 3168.458	USGS MON @ SE COR BRIDGE #53-313 5M S/O C/L PEARBLOSSOM HWY MKD (GAGING STA)	L 5835
LLANO (1998)	0967.584 3174.482	DPW BM TAG IN NE COR CONC SLAB @ SW COR 165TH ST E & PEARBLOSSOM HWY 9M W & 16M S/O C/L INT 2.6M S/O PP #661279H	L 5836
LLANO (1998)	0966.990 3172.533	50MM IP W/CONC PLUG & DPW BM TAG 450MM W/O TP STUB #39 @ SE COR 165TH ST E & PEARBLOSSOM HWY 16M S & 19M E/O C/L INT	L 5837
LLANO (1998)	1039.978 3411.994	USC&GS MON 18M S C/L PEARBLOSSOM HWY & 563M E/O 198TH ST E MKD (LARGO VISTA RS NO 1 1925) 402M W/O LARGO VISTA RD MKR POST 8.3M N/O MON	L 5838

QUAD-YEAR	ELEV METER/FOOT	DESCRIPTION (INCLUDE QUAD AND YEAR IN DESCRIPTION)	BM NUMBER
LLANO (1998)	1039.264 3409.652	DPW BM TAG IN NW COR OF CONC ELEC BOX PAD @ SW COR PEARBLOSSOM HWY & LAGRO VISTA RD 42.5M W & 15M S/O C/L INT 2.6M E/O TP STUB #60	L 5839
LLANO (1998)	1038.639 3407.601	50MM IP W/O CONC PLUG & DPW BM TAG 1.5M N CALL BOX #18.43 @ NE COR PALMDALE RD & 223RD ST 8M E & 11.3M N/O C/L INT	L 5840
LLANO (1998)	1038.026 3405.590	40MM IP W/PLUG & N 9.6M S/O C/L PALMDALE RD & 1.2K E/O ANTELOPE HWY #138 MKD (GPS #0129) MKR POST 1M E/O MON	L 5841
LLANO (1998)	1014.684 3329.009	CS MON 200MM DN 3.4M E/O C/L 233RD ST E ON C/L PROD OF DIRT RD FROM THE W 805M N/O PALMDALE RD 11M SELY/O PP (NO#) MKR (1/4 COR 21,22,T5N,R8W) MKR POST 480MM NE/O MON	L 5842
LLANO (1998)	0964.819 3165.410	L&T IN E END CONC HDWL 6M N/O C/L AVE U & 33M W/O C/L 235TH ST E @ MI MKR #23.49	L 5843
LLANO (1998)	0917.286 3009.462	50MM IP W/O CONC PLUG & DPW BM TAG FLUSH 18M W/O C/L 235TH ST E & 4.6M N/O C/L AVE S MKR POST 150MM W/O MON	L 5844
LLANO (1998)	0908.056 2979.180	50MM IP W/CONC PLUG & DPW BM TAG @ NE COR 235TH ST E & AVE R-8 14M E & 6.7M N/O C/L INT 1M N/O ST SIGN POST	L 5845
LLANO (1998)	0899.667 2951.657	50MM IP W/CONC PLUG & CS TAG @ SW COR 235TH ST E & AVE R (DIRT RD) 18M S & 23M W/O C/L INT MKR POST 600MM W/O MON	L 5846
LLANO (1998)	0894.673 2935.273	CS MON IN WELL 600MM DN @ C/L INT PALMDALE BLVD & 240TH ST E MKD (1/4 COR 27,28,T6N,R8W,RE 7729)	L 5847
BASELINE (1998)	0846.152 2776.084	50MM IP W/DPW BM TAG 75MM UP 9M N/O C/L AVE M (DIRT RD) NR 225TH ST E MKR POST 600MM N/O MON	L 5848
BASELINE (1998)	0840.723 2758.272	CS MON 100MM UP @ NE COR AVE M & 220TH ST E 4.3M N & 12M E/O C/L INT MKD (ADOBE MTN B 13 RM 1 1972 RE 7078) MKR POST 600MM NW/O MON	L 5849
BASELINE (1998)	0840.393 2757.189	CS MON FLUSH @ NW COR AVE M & 220TH ST E 8.5M W & 14.3M N/O C/L INT MKD (ADOBE MTN B 13 RM 2 1972 RE 7078) MKR POST 600MM SW/O MON	L 5850
BASELINE (1998)	0795.611 2610.267	50MM IP W/CE TAG @ NE COR AVE M & 180TH ST E 14M E & 7M N/O C/L INT	L 5851

QUAD-YEAR	ELEV METER/FOOT	DESCRIPTION (INCLUDE QUAD AND YEAR IN DESCRIPTION)	BM NUMBER
BASELINE (1998)	0791.583 2597.052	50MM IP W/CS TAG 250MM UP 15M N/O C/L AVE M ON C/L 175TH ST E MKR POST 1.5M S/O MON	L 5852
LLANO (1998)	0846.491 2777.196	DPW BM TAG IN SE COR CONC SLAB @ SW COR 150TH ST E & PALMDALE BLVD 27M S & 8M W/O C/L INT	L 5853
BASELINE (1998)	0809.566 2656.051	DPW BM TAG IN E CB 6.5M S/O BCR @ SE COR 95TH ST E & PALMDALE BLVD 30M S & 10M E/O C/L INT	L 5854
BASELINE (1998)	0797.921 2617.846	DPW BM TAG IN NE COR CONC EDISON VAULT 28M E & 9.4M S/O C/L INT 150TH ST E & AVE N-8	L 5855
BASELINE (1998)	0807.752 2650.100	50MM IP W/CONC PLUG & DPW BM TAG 1.5M E/O PP (NO#) @ NE COR 150TH ST E & AVE O 10M E & 16.5M N/O C/L INT	L 5856
BASELINE (1998)	0807.076 2647.882	MON IN WELL 700MM DN @ C/L INT AVE O & 145TH ST E	L 5857
BASELINE (1998)	0816.461 2678.672	50MM IP W/CONC PLUG & 42 SHELL CASING 150MM UP @ NW COR AVE O & 140TH ST E 12.5M N & 12.5M W/O C/L INT 5M NW/O PP (NO#)	L 5858
BASELINE (1998)	0846.047 2775.739	40MM IP W/CONC PLUG & NAIL 300MM DN @ NW COR AVE O & LONGVIEW RD 18M N & 18M W/O C/L INT MKR POST 600MM N/O MON	L 5859
BASELINE (1998)	0846.640 2777.685	50MM IP W/CONC PLUG & DPW BM TAG 1M E PP (NO#) @ NE COR AVE O & 130TH ST E 13M N & 13.5M E/O C/L INT	L 5860
BASELINE (1998)	0798.122 2618.505	50MM IP W/CONC PLUG & DPW BM TAG 1M E/O WLY MOST PP STUB 4.5M W C/L 115TH ST E & 23M N/O C/L AVE O	L 5861
BASELINE (1998)	0794.903 2607.944	50MM IP W/CONC PLUG & DPW BM TAG 1.5M E/O PP #1062411E @ NE COR AVE O & 110TH ST E 9.4M E & 9.8M N/O C/L INT	L 5862
BASELINE (1998)	0795.199 2608.915	DPW BM TAG IN S SIDE CONC BASE OF WATER DIST MH @ SW COR AVE O & 110TH ST E 7M W & 25M S/O C/L INT	L 5863
BASELINE (1998)	0789.596 2590.533	50MM IP W/CONC PLUG & DPW BM TAG 1M E/O PP #2145388E @ SW COR AVE O & 100TH ST E 7M S & 5M W/O C/L INT	L 5864
BASELINE (1998)	0788.039 2585.425	50MM IP W/CONC PLUG & DPW BM TAG @ NW COR AVE O & 95TH ST E 15M N & 15M W/O C/L INT	L 5865

QUAD-YEAR	ELEV METER/FOOT	DESCRIPTION (INCLUDE QUAD AND YEAR IN DESCRIPTION)	BM NUMBER
LLANO (1998)	0808.729 2653.305	DPW BM TAG IN W CB 300MM N/O BCR @ NW COR AVE & 170TH ST E 13M W & 24M N/O C/L INT @ F HYD	L 5866
LLANO (1998)	0808.644 2653.026	L&NAIL IN E CB 300MM N/O BCR @ NE COR AVE O & 170TH ST E 12.5M E & 23.5M N/O C/L INT	L 5867
LLANO (1998)	0813.743 2669.755	L&T IN S CB 300MM E/O BCR @ SE COR 180TH ST E & AVE O 20M E & 10M S/O C/L INT	L 5868
LLANO (1998)	0821.461 2695.077	50MM IP W/CONC PLUG & CE TAG FL @ NW COR AVE O & FUT 195TH ST E 15M N & 15M W/O C/L INT	L 5869
LLANO (1998)	0831.937 2729.447	50MM IP W/CONC PLUG & CE TAG 300MM UP @ SE COR AVE O & 205TH ST E 15M S & 15M E/O C/L INT	L 5870
LLANO (1998)	0837.042 2746.195	50MM IP W/CONC PLUG & BRAD @ SE COR AVE O & 210TH ST E 15M S & 15M E/O C/L INT	L 5871
LLANO (1998)	0862.150 2828.570	50MM IP W/PLUG & CE TAG @ SW COR AVE O & 230TH ST E 15M S & 15M W/O C/L INT 31M SW/O PP (NO#)	L 5872
LLANO (1998)	0819.971 2690.188	50MM IP W/CONC PLUG & DPW BM TAG 600MM W/O PP #767666E 45M S & 10.4M W/O C/L INT 180TH ST E & LAKE LOS ANGELES AVE	L 5873
LLANO (1998)	0809.665 2656.376	DPW BM TAG IN S CB 450MM E/O BCR @ SE COR 95TH ST E & PALMDALE BLVD 20M E & 13M S/O C/L INT	L 5874
LLANO (1998)	0813.791 2669.913	DPW BM TAG IN CONC HDWL @ SE COR PALMDALE BLVD & 100TH ST E 12M E & 11.5M S/O C/L INT	L 5875
LLANO (1998)	0816.407 2678.495	DPW BM TAG IN IN CTR CONC HDWL @ SW COR 105TH ST E & PALMDALE BLVD 11M S & 7.6M W/O C/L INT	L 5876
LLANO (1998)	0816.512 2678.840	DPW BM TAG IN S END CONC HDWL @ SE COR 105TH ST E & PALMDALE BLVD 11M S & 8M E/O C/L INT	L 5877
LLANO (1998)	0829.617 2721.835	50MM IP W/DPW BM TAG 1.5M N/O PP #4400380E 10M N C/L PALMDALE BLVD & 27.5M E/O FUT 125TH ST E	L 5878
LLANO (1998)	0832.263 2730.516	50MM IP W/DPW BM TAG 1.5M NW/O PP #4400392E 10M N C/L PALMDALE BLVD & 35.5M E/O C/L 130TH ST E	L 5879
LLANO (1998)	0836.409 2744.119	DPW TAG IN E END CONC HDWL @ SE COR PALMDALE BLVD & LONGVIEW RD 13M E & 6.4M S/O C/L INT	L 5880
LLANO (1998)	0839.777 2755.168	50MM IP W/DPW TAG 600MM E/O PP #1190822E @ NW COR PALMDALE BLVD & 140TH ST E (N) 51M W & 9M N/O C/L INT	L 5881

QUAD-YEAR	ELEV METER/FOOT	DESCRIPTION (INCLUDE QUAD AND YEAR IN DESCRIPTION)	BM NUMBER
LLANO (1998)	0840.085 2756.179	50MM IP W/DPW TAG 1M N/O PP #1190823E @ NE COR PALMDALE BLVD & 140TH ST E (N) 14M E & 10M N/O C/L INT	L 5882
LLANO (1998)	0849.327 2786.500	DPW BM TAG IN N END CONC FTG OF WLY GATE PILLAR 4M W C/L PROD 160TH ST E & 11M S/O C/L PALMDALE BLVD	L 5883
LLANO (1998)	0849.848 2788.210	DPW BM TAG 1.6M S/O NE COR CONC PORCH TO HSE #17012 PALMDALE BLVD 31.4M S/O C/L & 88.4M E/O C/L 170TH ST E	L 5884
LLANO (1998)	0857.984 2814.903	25MM IP & LS TAG #4089 75MM UP 15M S/O PALMDALE BLVD & 3M W/O FUT 195TH ST E (DIRT RD)	L 5885
LLANO (1998)	0860.858 2824.332	CS MON IN WELL 270MM DN @ C/L INT PALMDALE BLVD & 200TH ST E MKD (SEC COR 25,30,T6N,R8W)	L 5886
LLANO (1998)	0888.370 2914.594	50MM IP & CE TAG 4.3M NE/O PP #2259572E @ NE COR PALMDALE BLVD & 230TH ST E 15M N & 15M E/O C/L INT	L 5887
LLANO (1998)	0893.173 2930.352	50MM IP & DPW BM TAG 1M S/O PP (NO#) @ SE COR PALMDALE BL & 235TH ST E 10M S & 10M E/O C/L INT	L 5888
LLANO (1998)	0838.523 2751.054	DPW BM TAG IN NW COR CONC DRWY TO HSE #11030 AVE S 15M S/O C/L & 55M E/O C/L 110TH ST E	L 5889
LLANO (1998)	0837.564 2747.908	CS MON IN WELL 450MM DN @ C/L INT 110TH ST E & AVE S	L 5890
LLANO (1998)	0831.187 2726.986	CS MON IN WELL 300MM DN @ C/L INT 110TH ST E & AVE R-8	L 5891
LLANO (1998)	0831.529 2728.108	DPW BM TAG IN SW COR CONC ELEC BOX PAD @ NE COR 110TH ST E & AVE R-8 30M E & 14M N/O C/L INT	L 5892
LLANO (1998)	0824.749 2705.864	L&T IN N CB 300MM W/O BCR @ NW COR 110TH ST E & AVE R 23M W & 10M N/O C/L INT	L 5893
LLANO (1998)	0890.931 2922.996	DPW BM TAG IN SW COR CONC PAD @ SE COR 165TH ST E & AVE T 13M S & 11M E/O C/L INT	L 5894
LLANO (1998)	0890.977 2923.147	50MM IP WITH CE TAG @ NW COR 165TH ST E & AVE T 15M N & 14.6M W/O C/L INT	L 5895
LLANO (1998)	0857.468 2813.210	50MM IP WITH DPW BM TAG @ NW COR 165TH ST E & AVE R 6.7M N & 40M W/O C/L INT 1M E/O PP #868	L 5896

QUAD-YEAR	ELEV METER/FOOT	DESCRIPTION (INCLUDE QUAD AND YEAR IN DESCRIPTION)	BM NUMBER
LLANO (1998)	1153.427 3784.202	50MM IP W/CONC PLUG & DPW BM TAG FLUSH @ SW COR FT TEJON RD & 233RD ST E 700MM W/O PP (NO#) 16.5M S & 14.3M W/O C/L INT	L 5897
LLANO (1998)	1152.955 3782.653	50MM IP W/CONC PLUG & DPW BM TAG FLUSH 600MM NW/O ST SIGN 5M E/O C/L 233RD ST E & 4M S/O C/L PROD FT TEJON RD	L 5898
LLANO (1998)	1113.156 3652.079	50MM IP W/CONC PLUG & DPW BM TAG FLUSH 1M N/O PP (NO#) 7M N & 6M W/O C/L INT 233RD ST E & AVE X-8	L 5899
LLANO (1998)	1221.552 4007.709	CS MON IN WELL DN 500MM 6.4M E/O PP (NO#) 11M N/O C/L DIRT RD AVE Y-8 & 805M S/O FT TEJON RD	L 5900
LLANO (1998)	1437.543 4716.339	DPW BM TAG IN S END OF ROCK & CONC HDWL 5M W/O LARGO VISTA RD & 4.8K S/O FT TEJON RD 1.9M N/O BIG PINES HWY 44M S/O PP #588335E	L 5901
LLANO (1998)	1584.089 5197.132	50MM IP W/CONC PLUG & DPW BM TAG 1M N/O PP (NO#) 8.7M S/O C/L BIG PINES HWY 563M W/O LARGO VISTA RD	L 5902
LLANO (1998)	1495.970 4908.028	DPW BM TAG IN SW COR CONC DRAIN LID 6.6M S/O C/L BIG PINES HWY & 2.6K W/O LARGO VISTA RD @ MI MKR #3.33	L 5903
LLANO (1998)	1389.282 4558.003	DPW BM TAG IN W END CONC DRAIN LID 7.5M S/O C/L BIG PINES HWY & 4.9K W/O LARGO VISTA RD 3.2K E/O BIG ROCK CREEK RD @ MI MKR #2.00	L 5904
LLANO (1998)	1197.689 3929.418	50MM IP W/CONC PLUG & DPW BM TAG 1M S/O PP (NO#) 7M S/O BIG PINES HWY & 53M W/O BIG ROCK CREEK RD	L 5905
LLANO (1998)	1108.031 3635.265	50MM IP 12M NELY/O BOBS GAP RD & 805M SE/O FORT TEJON RD 13M W/O DIRT DRWY	L 5906
LLANO (1998)	1140.540 3741.922	50MM IP @ SE COR 165TH ST E & AVE X (PVT) 15.6M S & 16M E/O C/L INT	L 5907
LLANO (1998)	1172.514 3846.823	BM TAG IN SE COR CONC PAD OF CONTROL BOX 38M E C/L LONGVIEW RD & 8.8M N/O C/L PALLET CREEK RD	L 5908
LLANO (1998)	1061.489 3482.568	DWR MON IN CONC 11.6M E/O C/L 165TH ST E & 68M N/O C/L CRYSTALAIRE DR MKD (3696 C 1968) MKR SIGN 300MM N/O MON	L 5909

QUAD-YEAR	ELEV METER/FOOT	DESCRIPTION (INCLUDE QUAD AND YEAR IN DESCRIPTION)	BM NUMBER
LLANO (1998)	1122.443 3682.548	CSBM MON 150MM UP 13M S/O C/L PALLETT CREEK RD & 2.2K E/O LONGVIEW RD 10M E/O MILE MKR #1.27 MKD (BM CR-12 RE 5869) MKR POST 600MM S/O MON	L 5910
LLANO (1998)	0992.581 3256.493	DPW BM TAG IN SE COR CONC PAD @ NE COR LONGVIEW RD & AVE W-8 17.4M E & 7.6M N/O C/L INT	L 5911
LLANO (1998)	0959.225 3147.057	DPW BM TAG IN W END HDWL @ SE COR LONGVIEW RD & AVE W 14M S & 6M E/O C/L INT	L 5912
LLANO (1998)	0959.185 3146.926	DPW BM TAG IN NW COR CONC F HYD PAD @ SE COR LONGVIEW RD & AVE W 27M E & 8M S/O C/L INT	L 5913
LLANO (1998)	0933.278 3061.930	USGS MON @ NW COR CONC DRAIN 8M E C/L LONGVIEW RD & 65M N/O AVE V-10 MKD (1964)	L 5914
LLANO (1998)	1219.070 3999.565	40MM IP W/CONC PLUG & SPK IN WELL 330MM DN @ C/L INT LONGVIEW RD & TUMBLEWEED RD	L 5915
LLANO (1998)	1273.344 4177.629	DPW BM TAG IN NW COR CONC PAD FOR BENCH @ NW COR LONGVIEW RD & MURPHY LN 29M N & 9M W/O C/L INT	L 5916
LLANO (1998)	1031.033 3382.647	DPW BM TAG IN NW COR CONC F HYD PAD @ SE COR AVE X & LONGVIEW RD 6.3M N & 19M S/O C/L INT	L 5917
LLANO (1998)	1274.994 4183.043	50MM IP W/CONC PLUG & DPW BM TAG FLUSH 2.3M S C/L PROD MURPHY LN & 6.3M E/O C/L LONGVIEW RD 400MM S/O PP (NO#)	L 5918
LLANO (1998)	1418.755 4654.699	DPW BM TAG IN NE COR CONC MAIL BOX PAD 10M N C/L JUNIPER HILLS RD & 9M W/O C/L 116TH ST E	L 5919
LLANO (1998)	1308.549 4293.131	DPW BM TAG IN SE COR CONC MAIL BOX PAD @ SE COR 106TH ST E & CIMA MESA RD 8M E & 28M S/O C/L INT	L 5920
LLANO (1998)	1228.743 4031.301	DPW BM TAG IN SE COR CONC MAILBOX PAD @ SE COR 106TH ST E & FOUR WINDS RD (PVT) 26M S & 7M E/O C/L INT @ HSE #30810	L 5921